

RECEIVED
NOV 18 1957
STATE ENGINEER
SALEM, OREGON

REGISTRATION NO. GR-226
CERTIFICATE NO. GR-702

Registration Statement

OF CLAIMANT OF RIGHT TO APPROPRIATE GROUND WATER

(Under Chapter 708, Oregon Laws 1955.)

TO THE STATE ENGINEER OF OREGON:

I, Walter L Childress
of Central Point County of Jackson

State of Oregon, do hereby make application for a certificate of registration as evidence of a right to appropriate ground water.

1. Source from which water is withdrawn is Pump well #1
(Flowing well, pump well, infiltration trench, or tunnel)
2. Location is: One mile east of Central Point
(Approximate distance and direction from nearest city or town)

and is more particularly described as follows:

(a) Well is located 2205.3 feet North and 767.4 feet East from SW cor./
(Give distance and bearing to corner of section or other legal subdivision)
being within NE 1/4 NW 1/4 SW 1/4 of Sec. 1, Twp. 37 S., Rge. E. 1/2
(Smallest legal subdivision) (N. or S.) (E. or W.)

or (b) within limits of recorded platted property, town or city:
in Lot _____, Blck _____ of _____
(Name of plat or addition)

County of _____
(If within city or town, give name)

3. Construction Work was begun on 1938; was completed on 1938
(Date) (Date)

and the ground water claimed was first used for the purposes set out below on 1939
(Date)

since which time the water has been used continuously
(Continuously or intermittently?)

from 1939 to date
(Date) (Date)

4. Quantity of water claimed and used is 36 gallons per minute; 26 acre feet per year.

5. Purpose or Purposes for which water is used irrigation

(Domestic, irrigation, municipal, manufacturing, industrial, etc.)

6. Description of Well: Depth 14 feet. Type dug
(Dug or drilled)

diameter 6 1/2 inches. Elevation of ground at well site 1260 feet, mean sea level.
(As near as known)

Depth to water table 10 feet.

7. Capacity of Well: 20 g.p.m. with 0.5 feet drawdown.

g.p.m. with _____ feet drawdown.

Date of test _____

If Flowing Well: Measured discharge _____ g.p.m. on _____
(Date)

Shut-in pressure at ground surface _____ lbs. per sq. in. on _____
(Date)

Water is controlled by _____
(Cap, valve, etc.)

If log of well is not available, give name and address of driller. Tom Harris, Gold Hill, Oregon

11. Infiltration Trench: Covered or open _____
 Dimensions: Length _____ ft. Minimum depth _____ ft. Maximum depth _____ ft.
 Bottom width _____ ft. Discharge _____ g.p.m. Date of test _____

12. Tunnel: Type of lining _____
 Dimensions: _____
(Length, course, and cross sectional size)
 Position of water bearing stratum with reference to portal of tunnel _____

Log of tunnel: (Preceding table for log of well may be used, if desired. Give footage from portal and character of materials, as pertinent.)

13. Pumping Equipment:
 (a) Pump 1.5 inch centrifugal pump Capacity 36 g.p.m.
(Make, type and size)
 (b) Motor 2.0 H.P. electric motor.
(Type and horsepower)

14. Location of area irrigated or to be irrigated, or place of use if for purposes other than irrigation.

Township North or South	Range E. or W. of Willamette Meridian	Section	Forty-acre Tract	Number Acres To Be Irrigated	Date of Reclamation
37 S.	2 W.	1	NW $\frac{1}{4}$ SW $\frac{1}{4}$	5.51 acres	1959

15. If the ground water supply is supplemental to an existing water supply, identification of any application for a permit, permit, certificate or adjudicated right to appropriate water made or held by the registrant.
 none

Township 37 South Range 2 West., W.M.

North

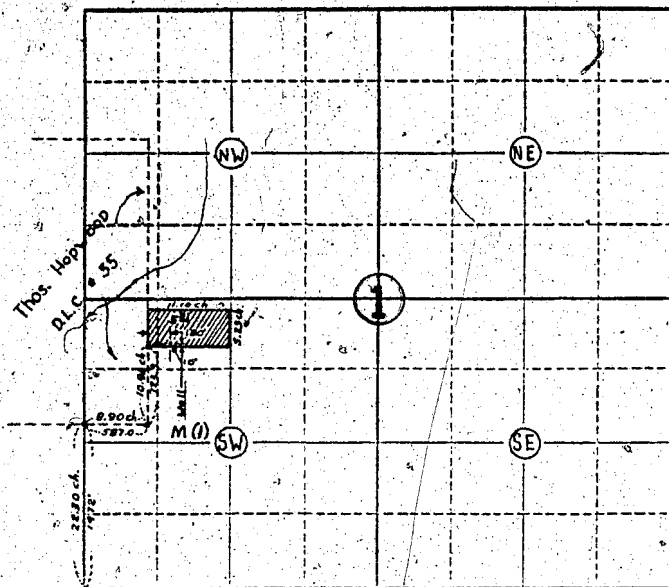

Locate well and acreage of irrigated land on plat.

Scale: 1" = 1 Mile
4" = 4 Miles

STATE OF OREGON

County of Jackson

ss.

I, Walter L. Childress, being first duly sworn, do hereby certify that I have read the foregoing Registration Statement and that all of the items therein contained are true to the best of my knowledge and belief.

Walter L. Childress
(Signature of Registrant)

Subscribed and sworn to before me this 26th day of January, 1956.

My commission expires February 7, 1958.

M. E. Dorell
(Notary Public)

(SEAL)

CERTIFICATE OF REGISTRATION

STATE OF OREGON

County of Marion

ss.

This is to certify that the foregoing Registration Statement was received in the office of the State Engineer on the 19th day of November, 1957, at 8:00 o'clock A.M. and has been duly recorded in said office in Book No. 1 of Registration Statements on page GR-702 C.

~~Construction shall be completed by 1958 and the water completely applied to beneficial use by 1958.~~

Witness my hand this 24th day of January, 1958.

Clara A. Stanley
(State Engineer)

By _____ (Deputy)

GR-702 C