

Registration Statement

OF CLAIMANT OF RIGHT TO APPROPRIATE GROUND WATER

TO THE STATE ENGINEER OF OREGON:

I, Ardele Edwards

of P.O. Box 350 Albany, Ore. County of Linn

State of Ore, do hereby make application for a certificate of registration as evidence of a right to appropriate ground water.

1. Source from which water is withdrawn is Well #2
(Flowing well, pump well, infiltration trench, or tunnel)

2. Location is: 10 mi. N of Albany, Ore.
(Approximate distance and direction from nearest city or town)

and is more particularly described as follows:

(a) 300' N of SE corner of Sec 31
(Give distance and bearing to corner of section or other legal subdivision)

being within SE 1/4 of SE 1/4 of Sec. 31, Twp. 9 S, Rge. 3 W
(Smallest legal subdivision) (N. or S.) (E. or W.)

or (b) within limits of recorded platted property, town or city:

in Lot _____, Block _____ of _____
(Name of plat or addition)

County of Linn
(If within city or town, give name)

3. Construction Work was begun on Apr. 1950; was completed on Apr. 1950
(Date) (Date)

and the ground water claimed was first used for the purposes set out below on 1950 Season
(Date)

since which time the water has been used Each Season
(Continuously or intermittently)

from June to Aug.
(Date) (Date)

4. Quantity of water claimed and used is 250 gallons per minute; _____ acre feet per year.

5. Purpose or Purposes for which water is used irrigation

(Domestic, irrigation, municipal, manufacturing, industrial, etc.)

6. Description of Well: Depth 26 feet. Type drilled
(Dug or drilled)

diameter 10 inches. Elevation of ground at well site 187 feet, mean sea level.
(As near as known)

Depth to water table 13' feet.

7. Capacity of Well: _____ g.p.m. with _____ feet drawdown.

_____ g.p.m. with _____ feet drawdown.

Date of test 7

If Flowing Well: Measured Discharge _____ g.p.m. on _____
(Date)

Shut-in pressure at ground surface _____ lbs. per sq. in. on _____
(Date)

Water is controlled by _____
(Cap, valve, etc.)

Township 9S Range 3W, W.M.
North

Oregon electric
R.P.

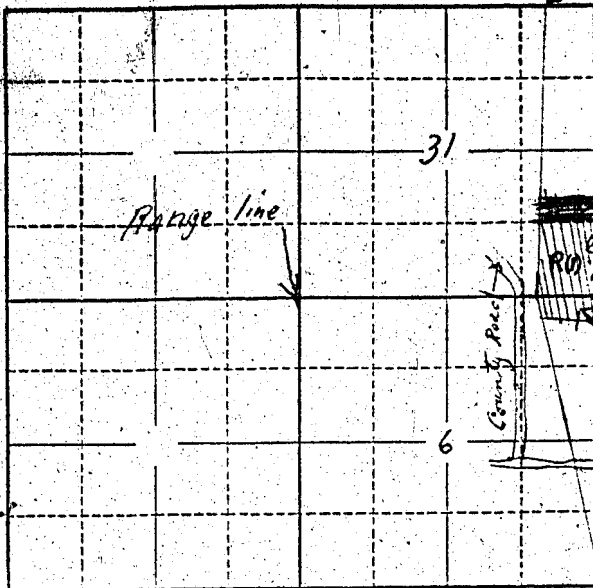

Locate well and acreage of irrigated land on plat.
Scale: 2" = 1 Mile

STATE OF OREGON

County of Marion

ss.

I, _____, being first duly sworn, do hereby certify that I have read the foregoing Registration Statement and that all of the items therein contained are true to the best of my knowledge and belief.

Ardle Edwards
(Signature of Registrant)

Subscribed and sworn to before me this 10th day of December, 1957

My commission expires June 12th 1961

Wm. S. Bartholomew
(Notary Public)

(SEAL)

CERTIFICATE OF REGISTRATION

STATE OF OREGON

County of Marion

ss.

This is to certify that the foregoing Registration Statement was received in the office of the State Engineer on the 10th day of December, 1957, at 9:00 o'clock A. M. and has been duly recorded in said office in Book No. _____ of Registration Statements on page GR-718 C.

Witness my hand this 21st day of January, 1958

Louis A. Stanley
(State Engineer)

By _____

(Deputy)

GR - 748 C