

# Registration Statement

## OF CLAIMANT OF RIGHT TO APPROPRIATE GROUND WATER

TO THE STATE ENGINEER OF OREGON:

I, Elmer or Vera J. Batehalder

of Rt. 1 Box 82 Hillsboro County of Washington

(Mailing address)

State of Oregon do hereby make application for a certificate of registration as evidence of a right to appropriate ground water.

1. Source from which water is withdrawn is Pump Well

(Flowing well, pump well, infiltration trench, or tunnel)

2. Location is: 6 1/2 mi. N.E. of Hillsboro & 3 mi. E. of North Plains

(Approximate distance and direction from nearest city or town)

and is more particularly described as follows:

(a) 1230' North & 50' West of Sections 4-5-8-9

(Give distance and bearing to corner of section or other legal subdivision)

being within SE 1/4 of SE 1/4 of Sec. 5, Twp. 1N, Rge. 2W

(Smallest legal subdivision)

(N. or S.)

(E. or W.)

or (b) within limits of recorded platted property, town or city:

in Lot \_\_\_\_\_, Block \_\_\_\_\_ of \_\_\_\_\_

(Name of plat or addition)

County of \_\_\_\_\_

(If within city or town, give name)

3. Construction Work was begun on March 1953; was completed on July 15 1953

(Date)

(Date)

and the ground water claimed was first used for the purposes set out below on August 1953

(Date)

since which time the water has been used Continuously

(Continuously or Intermittently)

from 1953 to Present time

(Date)

(Date)

4. Quantity of water claimed and used is 250 gallons per minute; \_\_\_\_\_ acre feet per year.

5. Purpose or Purposes for which water is used irrigation

(Domestic, irrigation, municipal, manufacturing, industrial, etc.)

6. Description of Well: Depth 546 feet. Type drilled

(Dug or drilled)

diameter 6" inches. Elevation of ground at well site \_\_\_\_\_ feet, mean sea level.

(As near as known)

Depth to water table 19' feet.

7. Capacity of Well: 250 g.p.m. with 66 feet drawdown;

300 g.p.m. with 88 feet drawdown.

Date of test July 2nd 1953

If Flowing Well: Measured discharge \_\_\_\_\_ g.p.m. on \_\_\_\_\_

(Date)

Shut-in pressure at ground surface \_\_\_\_\_ lbs. per sq. in. on \_\_\_\_\_

(Date)

Water is controlled by \_\_\_\_\_

(Cap, valve, etc.)

8. Casing: (Give diameter, commercial specifications and depth below ground surface of each casing size.)

6 inch diameter ..... from 0 to 277 feet  
 ..... inch diameter ..... from ..... to ..... feet  
 ..... inch diameter ..... from ..... to ..... feet  
 ..... inch diameter ..... from ..... to ..... feet

Describe and show depth of shoe, plug, adapter, liner or other details:  
 .....  
 .....

9. Perforated Casings or Screens:

..... from ..... to .....  
 (Number per foot and size of perforations, or describe screen)  
 ..... from ..... to .....  
 ..... from ..... to .....  
 ..... from ..... to .....

10. Log of Well: (Describe each stratum or formation clearly, indicate if water bearing, and give thickness and depth as indicated.)

MATERIAL	Thickness (Feet)	Depth to Bottom (Feet)
Top soil	6	
Yellow clay	6	34
Blue & yellow clay	34	78
Red clay	78	102
blue clay	102	131
sticky red clay	131	146
clay iron oxide	146	169
dark red clay	169	195
blue & gray clay	195	236
yellow sandy clay	236	267
Hard sand rock	267	277
basalt rock	277	336
yellow shale	336	342
basalt rock	342	491
Honey comb rock - water	491	501
Hard gray basalt	501	534
Hard rock - water	534	541
Hard basalt	541	547



Township 1N Range 2W, W.M.  
North

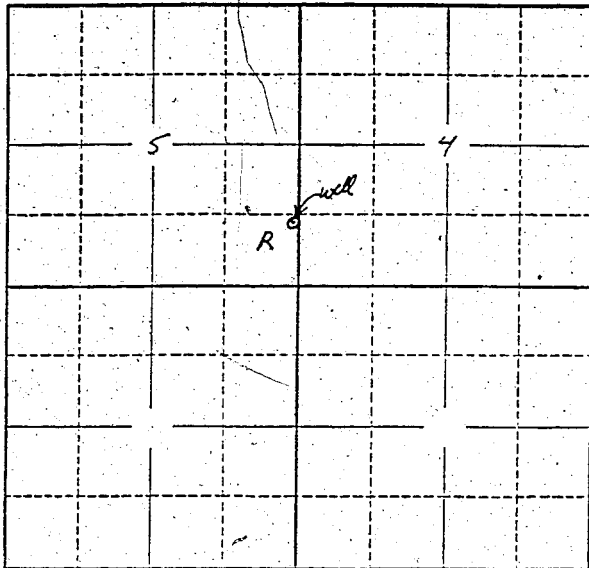

Locate well and acreage of irrigated land on plat.  
Scale: 2" = 1 Mile

STATE OF OREGON

County of Washington } ss.

I, Elmer W. Patchelder, being first duly sworn, do hereby certify that I have read the foregoing Registration Statement and that all of the items therein contained are true to the best of my knowledge and belief.

(Signature of Registrant)

Subscribed and sworn to before me this 2<sup>nd</sup> day of December, 1957

MY COMMISSION EXPIRES MARCH 21, 1959

My commission expires

E. J. [Signature]  
(Notary Public)

(SEAL)

**CERTIFICATE OF REGISTRATION**

STATE OF OREGON

County of Marion } ss.

This is to certify that the foregoing Registration Statement was received in the office of the State Engineer on the 17<sup>th</sup> day of December, 1957, at 8<sup>00</sup> o'clock A. M. and has been duly recorded in said office in Book No. 7 of Registration Statements on page GR-1516

Witness my hand this 1<sup>st</sup> day of December, 1958

[Signature]  
(State Engineer)

By \_\_\_\_\_  
(Deputy)

\$15.00

GR - 1516