

Registration Statement

OF CLAIMANT OF RIGHT TO APPROPRIATE GROUND WATER

TO THE STATE ENGINEER OF OREGON:

I, Lester Will

of Hubbard Oregon R. 1 Box 38 County of Marion

State of Oregon, do hereby make application for a certificate of registration as evidence of a right to appropriate ground water.

1. Source from which water is withdrawn is Pumped Well
(Flowing well, pump well, infiltration trench, or tunnel)

2. Location is: 1/2 M. N. Hubbard
(Approximate distance and direction from nearest city or town)

and is more particularly described as follows:

(a) 2250'S 4 200' E from NW corner Section 26
(Give distance and bearing to corner of section or other legal subdivision)

being within SW 1/4 NW 1/4 of Sec. 26, Twp. 4 S, Rge. 1 W
(Smallest legal subdivision) (N. or S.) (E. or W.)

or within limits of recorded platted property, town or city:

in Lot _____, Block _____ of _____
(Name of plat or addition)

County of _____
(If within city or town, give name)

3. Construction Work was begun on 12-26-1933; was completed on 1-1-33
(Date) (Date)

and the ground water claimed was first used for the purposes set out below on 12-26-33
(Date)

since which time the water has been used Continuously
(Continuously or Intermittently)

from 1-1-33 to Sept
(Date) (Date)

4. Quantity of water claimed and used is 250 gallons per minute; _____ acre feet per year.

5. Purpose or Purposes for which water is used 178-19-1

(Domestic, irrigation, municipal, manufacturing, industrial, etc.)

6. Description of Well: Depth 140 feet. Type 50' x 12'
(Dug or drilled)

diameter _____ inches. Elevation of ground at well site 178 feet, mean sea level.
(As near as known)

Depth to water table 27 feet.

7. Capacity of Well: 5 g.p.m. with _____ feet drawdown.

_____ g.p.m. with _____ feet drawdown.

Date of test _____

If Flowing Well: Measured discharge _____ g.p.m. on _____
(Date)

Shut-in pressure at ground surface _____ lbs. per sq. in. on _____
(Date)

Water is controlled by _____
(Cap, valve, etc.)

8. Casing: (Give diameter, commercial specifications and depth below ground surface of each casing size.)

10 inch diameter from 0 to 100 feet
 inch diameter from to feet
 inch diameter from to feet
 inch diameter from to feet

Describe and show depth of shoe, plug, adapter, liner or other details:
 no shoe

9. Perforated Casings or Screens:

no perforation from to
(Number per foot and size of perforations, or describe)
 from to
 from to
 from to

10. Log of Well: (Describe each stratum or formation clearly, indicate if water bearing, and give thickness and depth as indicated.)

MATERIAL	Thickness (Feet)	Depth to Bottom (Feet)
log not available		

If log of well is not available, give name and address of driller. J.T. Miller

11. Infiltration Trench: Covered or open _____

Dimensions: Length _____ ft. Minimum depth _____ ft. Maximum depth _____ ft.

Bottom width _____ ft. Discharge _____ g.p.m. Date of test _____

12. Tunnel: Type of lining _____

Dimensions: _____
(Length, course, and cross sectional size)

Position of water bearing stratum with reference to portal of tunnel _____

Log of tunnel: (Preceding table for log of well may be used, if desired. Give footage from portal and character of materials, as pertinent.)

13. Pumping Equipment:

(a) Pump Turbine Capacity 2.50 g.p.m.
(Make, type and size)

(b) Motor D.H.P.
(Type and horsepower)

14. Location of area irrigated or to be irrigated, or place of use if for purposes other than irrigation.

Township North or South	Range E. or W. of Willamette Meridian	Section	Forty-acre Tract	Number Acres To Be Irrigated	Date of Reclamation
4.5	1W	26	SW $\frac{1}{4}$ NW $\frac{1}{4}$	17	5/1953
4.5	1W	27	SE $\frac{1}{4}$ NE $\frac{1}{4}$	15	5/1953
				<u>32 Total</u>	

15. If the ground water supply is supplemental to an existing water supply, identification of any application for a permit, permit, certificate or adjudicated right to appropriate water made or held by the registrant.

Township 45 Range 1W W.M.
North

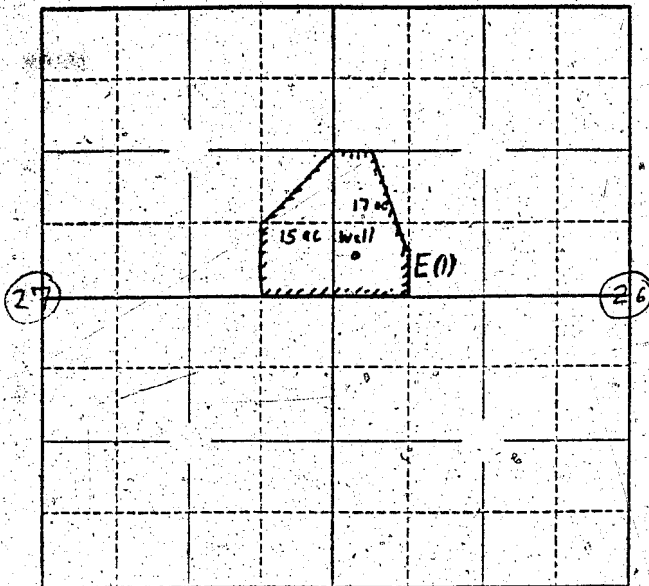

Locate well and acreage of irrigated land on plat.

Scale: $\frac{1}{4}$ - 1 Mile
4

STATE OF OREGON

County of Marion } ss.

I, Lester Will, being first duly sworn, do hereby certify that I have read the foregoing Registration Statement and that all of the items therein contained are true to the best of my knowledge and belief.

Lester Will
(Signature of Registrant)

Subscribed and sworn to before me this 11th day of December, 1957.

My commission expires Sept. 9, 1960

John S. White
(Notary Public)

(SEAL)

CERTIFICATE OF REGISTRATION

STATE OF OREGON } ss.
County of Marion

This is to certify that the foregoing Registration Statement was received in the office of the State Engineer on the 12 day of December, 1957, at 10:00 o'clock A.M. and has been duly recorded in said office in Book No. 4 of Registration Statements on page GR-759 C

Witness my hand this 4th day of February, 1958

Lewis A. Stanley
(State Engineer)

By _____ (Deputy)

GR - 759 C