

RECEIVED
DEC 17 1957
STATE ENGINEER
SALEM, OREGON

Registration No. GR-772
Certificate No. GR-767

Registration Statement

OF CLAIMANT OF RIGHT TO APPROPRIATE GROUND WATER

TO THE STATE ENGINEER OF OREGON:

I, Rosamond W. Zimmerman

of 5923 Table Rock Road, Central Point, County of Jackson

State of Oregon do hereby make application for a certificate of registration as evidence of a right to appropriate ground water.

1. Source from which water is withdrawn is pump well
(Flowing well, pump well, infiltration trench, or tunnel)
2. Location is: 3 miles Northeast of Central Point, Oregon
(Approximate distance and direction from nearest city or town)

and is more particularly described as follows:

- (a) 650 feet South and 626 feet West from the NE corner Sec. 26
(Give distance and bearing to corner of section or other legal subdivision)
being within S $\frac{1}{2}$ N $\frac{1}{2}$ NE $\frac{1}{4}$ NW $\frac{1}{4}$ of Sec. 36, Twp. 36 S., Rge. 2 W.
(Smallest legal subdivision) (N. or S.) (E. or W.)
- or (b) within limits of recorded platted property, town or city:
in Lot _____, Block _____ of _____
(Name of plat or addition)

County of _____
(If within city or town, give name)

3. Construction Work was begun on May 1950; was completed on July 1950
(Date) (Date)
and the ground water claimed was first used for the purposes set out below on May 1951
(Date)
since which time the water has been used continuously
(Continuously or intermittently)
from May 1951 to date
(Date) (Date)

4. Quantity of water claimed and used is 80 gallons per minute; 1.5 acre feet per year.

5. Purpose or Purposes for which water is used irrigation
(Domestic, irrigation, municipal, manufacturing, industrial, etc.)

6. Description of Well: Depth 40 feet. Type dug
(Dug or drilled)
diameter 1' x 1' Elevation of ground at well site 1265 feet, mean sea level.
(As near as known)
Depth to water table 22 feet.

7. Capacity of Well: 80 g.p.m. with 0.0 feet drawdown.
_____ g.p.m. with _____ feet drawdown.
Date of test noted from use

If Flowing Well: Measured discharge _____ g.p.m. on _____
(Date)

Shut-in pressure at ground surface 0 lbs. per sq. in. on _____
(Date)

Water is controlled by _____
(Cap. valve, etc.)

Township 36 S. Range 2 W., W.M.

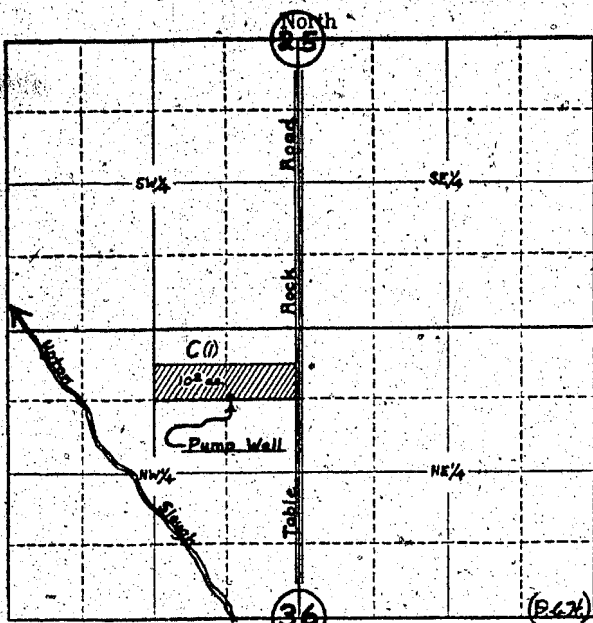

Locate well and acreage of irrigated land on plat.

Scale: 4" = 1 Mile

STATE OF OREGON

County of Jackson

I, Richard Zimmerman, being first duly sworn, do hereby certify that I have read the foregoing Registration Statement and that all of the items therein contained are true to the best of my knowledge and belief.

Richard Zimmerman
(Signature of Registrant)

Subscribed and sworn to before me this 13th day of November, 1957

My commission expires Nov. 23 - 1960

Richard Hill
(Notary Public)

(SEAL)

CERTIFICATE OF REGISTRATION

STATE OF OREGON

County of Marion

This is to certify that the foregoing Registration Statement was received in the office of the State Engineer on the 17 day of December, 1957, at 8:00 o'clock A.M. and has been duly recorded in said office in Book No. 4 of Registration Statements on page GR-767 C

Witness my hand this 4th day of February, 1958

4/5-22

Lewis A. Stanley
(State Engineer)

By _____ (Deputy)

GR - 767 C