

Registration No. GR-723

Certificate No. GR-768

Registration Statement

OF CLAIMANT OF RIGHT TO APPROPRIATE GROUND WATER

TO THE STATE ENGINEER OF OREGON:

I, Ray W. Bates
of Box 374 Bandon County of Cook
State of Oregon do hereby make application for a certificate of registration as evidence of a right to appropriate ground water.

- 1. Source from which water is withdrawn is Pumped #1
(Flowing well, pump well, infiltration trench, or tunnel)
- 2. Location is: 1 Mi. Bandon
(Approximate distance and direction from nearest city or town)

and is more particularly described as follows:

(a) 750' E + 740.5' from NW Corner S291
(Give distance and bearing to corner of section or other legal subdivision)
being within NW 1/4 NW 1/4 of Sec. 29, Twp. 28 S, Rge. 14 W
(Smallest legal subdivision) (N. or S.) (E. or W.)

or (b) within limits of recorded platted property, town or city:
in Lot _____ Block _____ of _____
(Name of plat or addition)
County of 3
(If within city or town, give name)

3. Construction Work was begun on 1936; was completed on 1936
(Date) (Date)
and the ground water claimed was first used for the purposes set out below on 1936
(Date)
since which time the water has been used Continuously
(Continuously or Intermittently)
from April 1936 to Nov. 1957
(Date) (Date)

4. Quantity of water claimed and used is 20 gallons per minute; _____ acre feet per year.

5. Purpose or Purposes for which water is used Irrigation
(Domestic, irrigation, municipal, manufacturing, industrial, etc.)

6. Description of Well: Depth 18 feet. Type Dug
(Dug or drilled)
diameter 36 inches. Elevation of ground at well site 60 feet, mean sea level.
(As near as known)
Depth to water table Flowing feet.

7. Capacity of Well: 0 g.p.m. with _____ feet drawdown.
_____ g.p.m. with _____ feet drawdown.

Date of test _____
If Flowing Well: Measured discharge 5 g.p.m. on 7-21
(Date)
Shut-in pressure at ground surface _____ lbs. per sq. in. on _____
(Date)
Water is controlled by No Control
(Cap. valve, etc.)

Township 28 S Range 14 W, W.M.
North

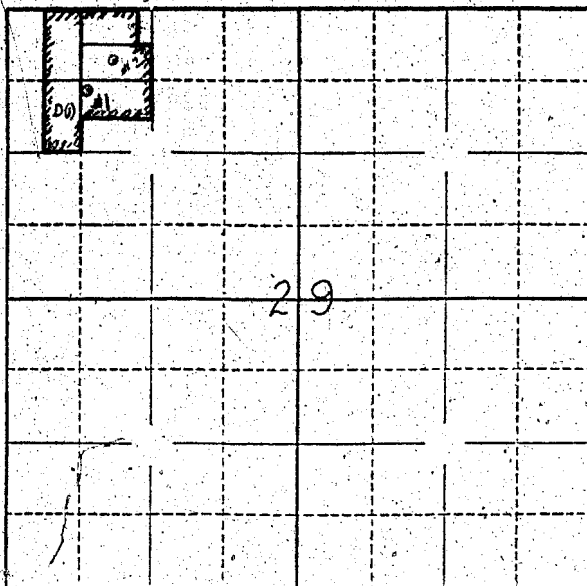

Locate well and acreage of irrigated land on plat.
Scale: $\frac{1}{2}$ " = 1 Mile

STATE OF OREGON

County of Marion } ss.

I, _____, being first duly sworn, do hereby certify that I have read the foregoing Registration Statement and that all of the items therein contained are true to the best of my knowledge and belief.

Ray W. Bates
(Signature of Registrant)

Subscribed and sworn to before me this 17th day of December, 1957.

My commission expires June 12th, 1961.
Wm. S. Bartholomew
(Notary Public)

(SEAL)

CERTIFICATE OF REGISTRATION

STATE OF OREGON

County of Marion } ss.

This is to certify that the foregoing Registration Statement was received in the office of the State Engineer on the 17 day of December, 1957, at 8:00 o'clock A. M. and has been duly recorded in said office in Book No. 4 of Registration Statements on page GR-768 C

Witness my hand this 4th day of February, 1958

Lewis A. Stanley
(State Engineer)

By _____
(Deputy)