

RECEIVED
SEP 8 1955
STATE ENGINEER
SALEM, OREGON

Registration Statement

OF CLAIMANT OF RIGHT TO APPROPRIATE GROUND WATER

(Under Chapter 708, Oregon Laws 1955.)

TO THE STATE ENGINEER OF OREGON:

I, Harry Bower

of P.O. Box 399 Eugene, Oregon County of Lane

State of Oregon do hereby make application for a certificate of registration as evidence of a right to appropriate ground water.

1. Source from which water is withdrawn is Pump Well
(Flowing well, pump well, infiltration trench, or tunnel)

2. Location is: Approx. 5 miles West of Eugene, Oregon
(Approximate distance and direction from nearest city or town)

and is more particularly described as follows:

(a) N.E. 1/4 of S.E. 1/4 of Sec. 31, T. 17 S, Range 4 W
(Give distance and bearing to corner of section or other legal subdivision)

being within N.E. 1/4 of S.E. 1/4 of Sec. 31 Twp. 17 S, Rge. 4 W
(Smallest legal subdivision) (N. or S.) (E. or W.)

or (b) within limits of recorded platted property, town or city:

in Lot _____, Block _____ of _____
(Name of plat, or addition)

County of Lane
(If within city or town, give name)

3. Construction Work was begun on 9-20-53; was completed on 9-24-53
(Date) (Date)

and the ground water claimed was first used for the purposes set out below on 4-20-54
(Date)

since which time the water has been used Irrigation of pasture - April to October
(Continuously or intermittently)
each year.

from _____ to _____
(Date) (Date)
4. Quantity of water claimed and used is 80 gallons per minute; Sprinkler and
4800 feet per year. water is used according to need, therefore do not know amount in
acre
per year.

5. Purpose or Purposes for which water is used Irrigate Pasture

(Domestic, irrigation, municipal, manufacturing, industrial, etc.)

6. Description of Well: Depth 70 feet. Type Drilled
(Dug or drilled)

diameter 6 inches. Elevation of ground at well site 406 feet, mean sea level.
(As near as known)

Depth to water table 18 feet.

7. Capacity of Well: 80 g.p.m. with 3 feet drawdown.

_____ g.p.m. with _____ feet drawdown.

Date of test 9-1-55

If Flowing Well: Measured discharge _____ g.p.m. on _____
(Date)

Shut-in pressure at ground surface _____ lbs. per sq. in. on _____
(Date)

Water is controlled by _____
(Cap, valve, etc.)

Township 17 Range 4 W.M.
North

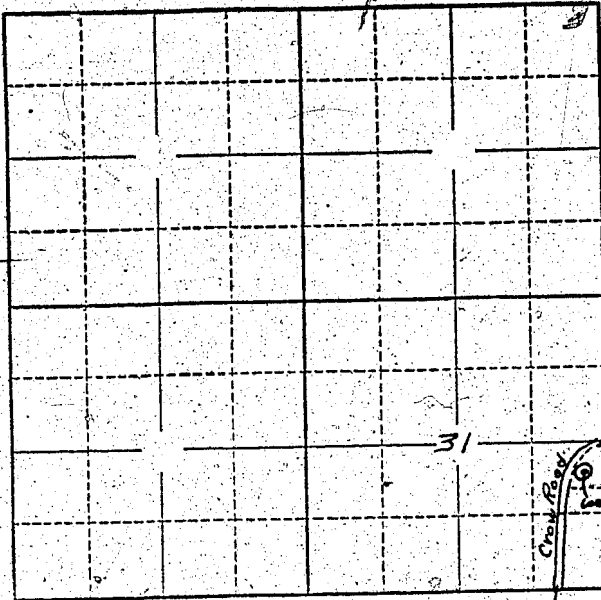

Locate well and acreage of irrigated land on plat
Scale: 2" = 1 Mile

STATE OF OREGON

County of Jane } ss.

I, HARRY BOWER, being first duly sworn, do hereby certify that I have read the foregoing Registration Statement and that all of the items therein contained are true to the best of my knowledge and belief.

Harry Bower
(Signature of Registrant)

Subscribed and sworn to before me this 7th day of Sept, 1955

My commission expires April 20, 1957

Ray Bowering
(Notary Public)

(SEAL)

CERTIFICATE OF REGISTRATION

STATE OF OREGON

County of Marion } ss.

This is to certify that the foregoing Registration Statement was received in the office of the State Engineer on the 8 day of September, 1955, at 8:00 o'clock A.M. and has been duly recorded in said office in Book No. 1 of Registration Statements on page 7

Construction shall be completed by _____, 19____, and the water is completely applied to beneficial use by _____, 19____.

Witness my hand this 24th day of February, 1956
Levo A. Stanley
(State Engineer)

By _____ (Deputy)