

396-

Registration No. GR-805

Certificate No. GR-780

Registration Statement

OF CLAIMANT OF RIGHT TO APPROPRIATE GROUND WATER

TO THE STATE ENGINEER OF OREGON:

I, Don L. Turnidge
of RT #1 Tetterson Ore - County of Marion
(Mailing address)

State of Oregon, do hereby make application for a certificate of registration as evidence of a right to appropriate ground water.

1. Source from which water is withdrawn is pump well # 396
(Flowing well, pump well, infiltration trench, or tunnel)

2. Location is: 9 mi. W. Tetterson
(Approximate distance and direction from nearest city or town)

and is more particularly described as follows: Beginning NW 1/4 Sec. 36 - Thence East 40 chains
Site 396 (a) NW 1/4 Sec. 36 - Thence South 7 chains
(Give distance and bearing to corner of section or other legal subdivision)

being within 36 of Sec. 36, Twp. 9 S, Rge. 4 W
(Smallest legal subdivision) (N. or S.) (E. or W.)

or (b) within limits of recorded platted property, town or city:

in Lot _____, Block _____ of _____
(Name of plat or addition)
County of Marion
(If within city or town, give name)

3. Construction Work was begun on 1939; was completed on 1939
(Date) (Date)

and the ground water claimed was first used for the purposes set out below on 1939
(Date)

since which time the water has been used Continuously (seasonly)
(Continuously or intermittently)

from 1939 to 1959
(Date) (Date)

4. Quantity of water claimed and used is 400 gallons per minute; _____ acre feet per year.

5. Purpose or Purposes for which water is used irrigation

(Domestic, irrigation, municipal, manufacturing, industrial, etc.)

6. Description of Well: Depth 30 feet. Type drilled
(Dug or drilled)

diameter 10 inches. Elevation of ground at well site 175 feet, mean sea level.
(As near as known)

Depth to water table 10 feet.

7. Capacity of Well: 500 g.p.m. with _____ feet drawdown.

est - 1000 g.p.m. with 3' feet drawdown.

Date of test _____

If Flowing Well: Measured discharge _____ g.p.m. on _____
(Date)

Shut-in pressure at ground surface _____ lbs. per sq. in. on _____
(Date)

Water is controlled by _____
(Csp. valve, etc.)

8. Casing: (Give diameter, commercial specifications and depth below ground surface of each casing size.)

1.0 inch diameter from 0 to 30 feet
inch diameter from to feet
inch diameter from to feet
inch diameter from to feet

Describe and show depth of shoe, plug, adapter, liner or other details:

9. Perforated Casings or Screens:

perforated from 15' to 30'
(Number per foot and size of perforations, or describe screen)
from to
from to
from to

10. Log of Well: (Describe each stratum or formation clearly, indicate if water bearing, and give thickness and depth as indicated.)

MATERIAL	Thickness (Feet)	Depth to Bottom (Feet)
silt	12'	12'
gravel	18'	30'

Township 9S Range 4W, W.M.
North

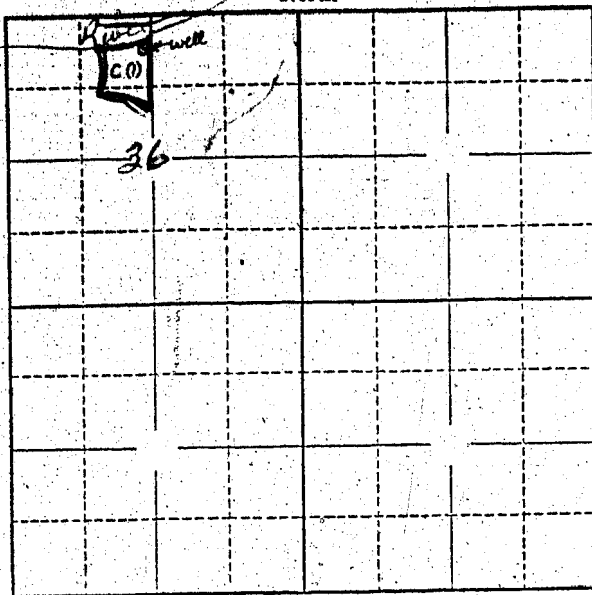

Locate well and acreage of irrigated land on plat.
Scale: 2" = 1 Mile

STATE OF OREGON

County of Marion } ss.

I, _____, being first duly sworn, do hereby certify that I have read the foregoing Registration Statement and that all of the items therein contained are true to the best of my knowledge and belief.

[Signature]
(Signature of Registrant)

Subscribed and sworn to before me this 18th day of December, 1957

My commission expires June 12, 1961

Wm. S. Bartholomew
(Notary Public)

(SEAL)

CERTIFICATE OF REGISTRATION

STATE OF OREGON

County of Marion } ss.

This is to certify that the foregoing Registration Statement was received in the office of the State Engineer on the 18 day of December, 1957, at 10:30 o'clock A.M. and has been duly recorded in said office in Book No. 4 of Registration Statements on page 780

Witness my hand this 21 day of February, 1958

[Signature]
(State Engineer)

By _____
(Deputy)

GR - 780 C