

RECEIVED
DEC 20 1937
STATE ENGINEER
SALE & EXCHANGE

Registration No. GR- 813

Certificate No. GR - 819

Registration Statement

OF CLAIMANT OF RIGHT TO APPROPRIATE GROUND WATER

TO THE STATE ENGINEER OF OREGON:

I, Hugh M. Howard
of Box 3 Junction City (Mailing address) County of Lane
State of Oregon do hereby make application for a certificate of registration as evidence of a right to appropriate ground water.

1. Source from which water is withdrawn is Pumps Well
(Flowing well, pump well, infiltration trench, or tunnel)

2. Location is: 3 miles north of Junction City
(Approximate distance and direction from nearest city or town)

and is more particularly described as follows:

(a) 62' to a point north and 242' West of S.E. Corner of Sec. 18
(Give distance and bearing to corner of section or other legal subdivision)

being within Sec. 18 of Sec. 18 Twp. 15 S. Rge. 4 W.
(Smallest legal subdivision) (N. or S.) (E. or W.)

or (b) within limits of recorded platted property, town or city:

in Lot _____, Block _____ of _____
(Name of plat or addition)

County of _____
(If within city or town, give name)

3. Construction Work was begun on 1939 was completed on 1939
(Date) (Date)

and the ground water claimed was first used for the purposes set out below on 1939
(Date)

since which time the water has been used Continuously
(Continuously or intermittently)

from May 15 to Sept 15
(Date) (Date)

4. Quantity of water claimed and used is 240 gallons per minute; 3 1/4 acre feet per year.

5. Purpose or Purposes for which water is used

Irrigation
(Domestic, irrigation, municipal, manufacturing, industrial, etc.)

6. Description of Well: Depth 26 feet. Type Driven
(Dug or drilled)

diameter 4 inches. Elevation of ground at well site 315 feet, mean sea level.
(As near as known)

Depth to water table 15 feet.

7. Capacity of Well: _____ g.p.m. with _____ feet drawdown.

_____ g.p.m. with _____ feet drawdown.

Date of test not tested

If Flowing Well: Measured discharge _____ g.p.m. on _____
(Date)

Shut-in pressure at ground surface _____ lbs. per sq. in. on _____
(Date)

Water is controlled by _____
(Cap. valve, etc.)

8. Casing: (Give diameter, commercial specifications and depth below ground surface of each casing size.)

..... inch diameter from to feet
 inch diameter from to feet
 inch diameter from to feet
 inch diameter from to feet

Describe and show depth of shoe, plug, adapter, liner or other details:

9. Perforated Casings or Screens:

..... from to
(Number per foot and size of perforations, or describe screen)
 from to
 from to
 from to

10. Log of Well: (Describe each stratum or formation clearly, indicate if water bearing, and give thickness and depth as indicated.)

MATERIAL	Thickness (feet)	Depth to Bottom (feet)
<i>In this territory there is on average of 6 ft of Wellamuth soil the balance is sand and gravel depth unknown</i>		

If log of well is not available, give name and address of driller.

11. Infiltration Trench: Covered or open

Dimensions: Length _____ ft. Minimum depth _____ ft. Maximum depth _____ ft.
 Bottom width _____ ft. Discharge _____ g.p.m. Date of test _____

12. Tunnel: Type of lining

Dimensions: _____
(Length, course, and cross-sectional size)
 Position of water bearing stratum with reference to portal of tunnel _____

Log of tunnel: (Preceding table for log of well may be used, if desired. Give footage from portal and character of materials, as pertinent.)

13. Pumping Equipment:

(a) Pump *Fairbanks Morse* *2 1/2"* Capacity *250* g.p.m.
(Make, type and size)
 (b) Motor *Electric* *10 H.P.*
(Type and horsepower)

14. Location of area irrigated or to be irrigated, or place of use if for purposes other than irrigation.

Township North or South	Range E. or W. of Willamette Meridian	Section	Forty-acre Tract	Number Acres To Be Irrigated	Date of Reclamation
<i>15 S.</i>	<i>4 W.</i>	<i>18</i>	<i>S.E. 1/4 of S.E. 1/4</i>	<i>3²</i>	<i>1939</i>
<i>" "</i>	<i>" "</i>	<i>19</i>	<i>N.E. 1/4 of N.E. 1/4</i>	<i>3²</i>	<i>" "</i>
<i>" "</i>	<i>" "</i>	<i>17</i>	<i>S.W. 1/4 of S.W. 1/4</i>	<i>10²</i>	<i>" "</i>
<i>" "</i>	<i>" "</i>	<i>20</i>	<i>N.W. 1/4 of N.W. 1/4</i>	<i>3²</i>	<i>" "</i>
				<i>19² total</i>	

15. If the ground water supply is supplemental to an existing water supply, identification of any application for a permit, permit, certificate or adjudicated right to appropriate water made or held by the registrant.

Township 15 S. Range 4 W. W.M.
North

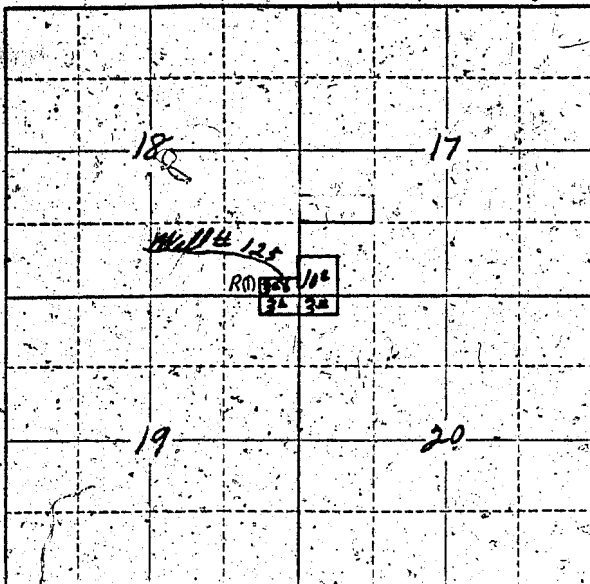

Locate well and acreage of irrigated land on plat.
Scale: 2" = 1 Mile

STATE OF OREGON

County of Clatsop } ss.

I, Raymond J. Howard, being first duly sworn, do hereby certify that I have read the foregoing Registration Statement and that all of the items therein contained are true to the best of my knowledge and belief.

Raymond J. Howard
(Signature of Registrant)

Subscribed and sworn to before me this 14th day of January, 1957

My commission expires 7-23-59
(Notary Public)

(SEAL)

CERTIFICATE OF REGISTRATION

STATE OF OREGON } ss.
County of Marion

This is to certify that the foregoing Registration Statement was received in the office of the State Engineer on the 20th day of December, 1957, at 11:00 o'clock P. M. and has been duly recorded in said office in Book No. 5 of Registration Statements on page 619

Witness my hand this 21 day of February, 1958

Lewis A. Stanley
(State Engineer)

By _____
(Deputy)