

# Registration Statement

## OF CLAIMANT OF RIGHT TO APPROPRIATE GROUND WATER

TO THE STATE ENGINEER OF OREGON:

I, Vernon G. Lund  
of 459 Bliler Ave. County of Marion  
(Mailing address)

State of Oregon do hereby make application for a certificate of registration as evidence of a right to appropriate ground water.

1. Source from which water is withdrawn is Pump Well  
(Flowing well, pump well, infiltration trench, or tunnel)
2. Location is: Rt # 1 Fiela Rd. 1 1/2 miles from Salem Oregon  
(Approximate distance and direction from nearest city or town)

and is more particularly described as follows:

(a) S 73° 43' W from NE Corner Section 16, - 833 ft  
(Give distance and bearing to corner of section or other legal subdivision)  
being within NE 1/4 NE 1/4 of Sec. 16, Twp. 7 S, Rge. 3 W  
(Smallest legal subdivision) (N. or S.) (E. or W.)

or (b) within limits of recorded platted property, town or city:  
in Lot \_\_\_\_\_, Block \_\_\_\_\_ of \_\_\_\_\_  
(Name of plat or addition)  
County of Polk  
(If within city or town, give name)

3. Construction Work was begun on July 1951; was completed on July 1951  
(Date) (Date)

and the ground water claimed was first used for the purposes set out below on Aug 20 1951  
(Date)  
since which time the water has been used Intermittently  
(Continuously or Intermittently)  
from Aug 1951 to Aug 1957  
(Date) (Date)

4. Quantity of water claimed and used is 400 gallons per minute; \_\_\_\_\_ acre feet per year.

5. Purpose or Purposes for which water is used Irrigation

6. Description of Well: Depth 147 feet. Type Cable  
(Domestic, irrigation, municipal, manufacturing, industrial, etc.) (Dug or drilled)  
diameter 8" inches. Elevation of ground at well site \_\_\_\_\_ feet, mean sea level.  
(As near as known)

Depth to water table \_\_\_\_\_ feet.

7. Capacity of Well: 470 g.p.m. with \_\_\_\_\_ feet drawdown.  
\_\_\_\_\_ g.p.m. with \_\_\_\_\_ feet drawdown.

Date of test Aug 20 1951

If Flowing Well: Measured discharge \_\_\_\_\_ g.p.m. on \_\_\_\_\_  
(Date)

Shut-in pressure at ground surface \_\_\_\_\_ lbs. per sq. in. on \_\_\_\_\_  
(Date)

Water is controlled by \_\_\_\_\_  
(Cap. valve, etc.)





Township 7S Range 3W, W.M.  
North

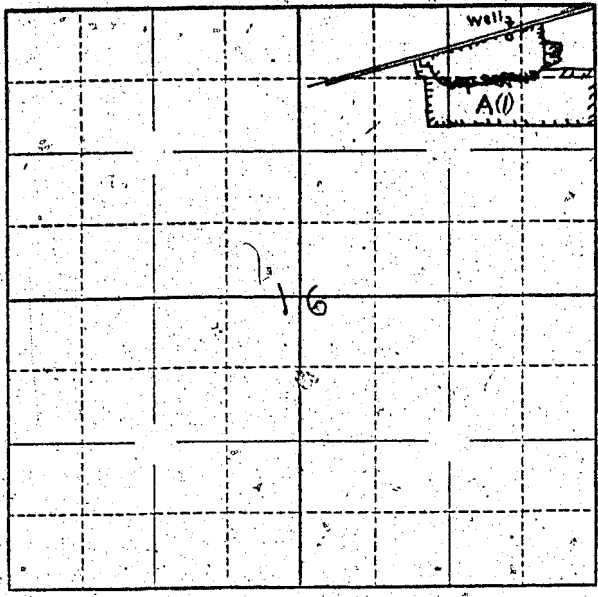

Locate well and acreage of irrigated land on plat.  
Scale: ~~1/4~~ = 1 Mile

STATE OF OREGON

County of Marion ss.

I, Vernon Land being first duly sworn, do hereby certify that I have read the foregoing Registration Statement and that all of the items therein contained are true to the best of my knowledge and belief.

Vernon Land  
(Signature of Registrant)

Subscribed and sworn to before me this 30 day of December, 1957.

My commission expires 9/27/58

Jeanie Baxter  
(Notary Public)

(SEAL)

**CERTIFICATE OF REGISTRATION**

STATE OF OREGON

County of Marion

This is to certify that the foregoing Registration Statement was received in the office of the State Engineer on the 30 day of December, 1956, at 8:00 o'clock A.M. and has been duly recorded in said office in Book No. 15 of Registration Statements on page 814.

Witness my hand this 21 day of February, 1958.

Lewis C. Stanley  
(State Engineer)

By \_\_\_\_\_ (Deputy)

GR - 814 C