

# Registration Statement

REGISTRATION NO. GR-872CERTIFICATE NO. GR-813

## OF CLAIMANT OF RIGHT TO APPROPRIATE GROUND WATER

(Under Chapter 708, Oregon Laws 1955.)

### TO THE STATE ENGINEER OF OREGON:

I, R. H. Quinlan  
of 1030 River Rd. Sweet Home, Ore. County of Lane  
State of Oregon, do hereby make application for a certificate of registration as evidence of a right to appropriate ground water.

1. Source from which water is withdrawn is Pump Well  
(Flowing well, pump well, infiltration trench, or tunnel)
2. Location is: 2 miles South-East Junction City  
(Approximate distance and direction from nearest city or town)

and is more particularly described as follows:

(a) 8 feet North and 22 1/2 feet west from center of Section 4  
(Give distance and bearing to corner of section or other legal subdivision)

being within SE 1/4 of NW 1/4 of Sec. 4, Twp. 16S, Rge. 4W  
(Smallest legal subdivision) (N. or S.) (E. or W.)

or (b) within limits of recorded platted property, town or city: 2 mile S.E. of Junction City  
in Lot \_\_\_\_\_, Block \_\_\_\_\_ of \_\_\_\_\_  
(Name of plat or addition)  
Junction City County of LANE  
(If within city or town, give name)

3. Construction Work was begun on July 53; was completed on July 53  
(Date) (Date)

and the ground water claimed was first used for the purposes set out below on July 53  
(Date)

since which time the water has been used Continuously  
(Continuously or Intermittently)

from July 53 to present  
(Date) (Date)

4. Quantity of water claimed and used is 300 gallons per minute; 8 acre feet per year.

5. Purpose or Purposes for which water is used Irrigation  
(Domestic, irrigation, municipal, manufacturing, industrial, etc.)

6. Description of Well: Depth 9 feet. Type Drilled  
(Dug or drilled)

diameter 5 inches. Elevation of ground at well site 335 feet, mean sea level.  
(As near as known)

Depth to water table 5 feet.

7. Capacity of Well: 30 g.p.m. with \_\_\_\_\_ feet drawdown.  
\_\_\_\_\_ g.p.m. with \_\_\_\_\_ feet drawdown.

Date of test Approx. Aug 53

If Flowing Well: Measured discharge \_\_\_\_\_ g.p.m. on \_\_\_\_\_ (Date)

Shut-in pressure at ground surface \_\_\_\_\_ lbs. per sq. in. on \_\_\_\_\_ (Date)

Water is controlled by \_\_\_\_\_  
(Cap. valve, etc.)

8. Casing: (Give diameter, commercial specifications and depth below ground surface of each casing size.)

5 inch diameter ..... from *fill to 9 1/2 in ground* to ..... feet  
 ..... inch diameter ..... from ..... to ..... feet  
 ..... inch diameter ..... from ..... to ..... feet  
 ..... inch diameter ..... from ..... to ..... feet

Describe and show depth of shoe, plug, adapter, liner or other details:

*plugged to last 4 1/2 ft*

9. Perforated Casings or Screens:

*See above* ..... from ..... to .....  
 (Number per foot and size of perforations, or describe screen)  
 ..... from ..... to .....  
 ..... from ..... to .....  
 ..... from ..... to .....

10. Log of Well: (Describe each stratum or formation clearly, indicate if water bearing, and give thickness and depth as indicated.)

MATERIAL	Thickness (Feet)	Depth to Bottom (Feet)
<i>None</i>		

If log of well is not available; give name and address of driller. *Oliver Hall, P.O. Dickman*  
*1280 Baker Road Home well*

11. Infiltration Trench: Covered or open

Dimensions: Length ..... ft. Minimum depth ..... ft. Maximum depth ..... ft.

Bottom width ..... ft. Discharge ..... g.p.m. Date of test .....

12. Tunnel: Type of lining

Dimensions: .....  
(Length, course, and cross sectional size)

Position of water bearing stratum with reference to portal of tunnel .....

Log of tunnel: (Preceding table for log of well may be used, if desired. Give footage from portal and character of materials, as pertinent.)

13. Pumping Equipment:

(a) Pump *Cornell* Capacity *300* g.p.m.  
(Make, type and size)

(b) Motor *15 HP*  
(Type and horsepower)

14. Location of area irrigated or to be irrigated, or place of use if for purposes other than irrigation.

Township North or South	Range E. or W. of Willamette Meridian	Section	Forty-acre Tract	Number Acres To Be Irrigated	Date of Reclamation
<i>16 S</i>	<i>4 W</i>	<i>4</i>	<i>SE 1/4 NW 1/4</i>	<i>20 A.</i>	<i>1953</i>
"	"	"	<i>NW 1/4 SE 1/4</i>	<i>12 A.</i>	<i>1953</i>
				<i>32 Ac</i>	

15. If the ground water supply is supplemental to an existing water supply, identification of any application for a permit, permit, certificate or adjudicated right to appropriate water made or held by the registrant:

Township 16 S Range 4 W W.M.  
North

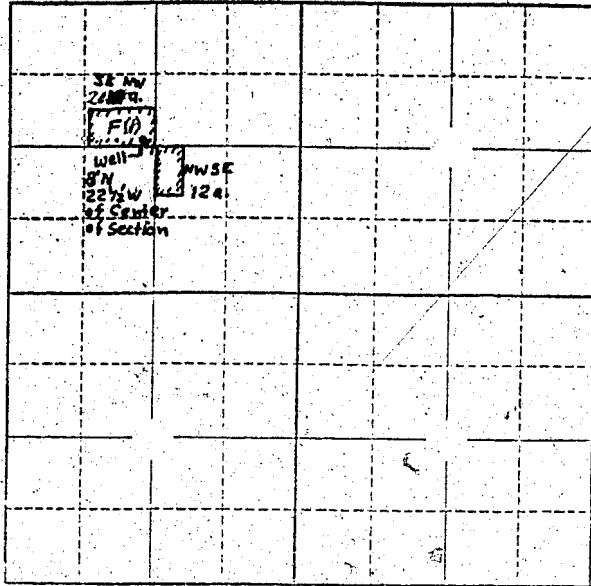

Locate well and acreage of irrigated land on plat.  
Scale: 2" = 1 Mile

STATE OF OREGON

County of Lane } ss.

I, L. H. Quintan, being first duly sworn, do hereby certify that I have read the foregoing Registration Statement and that all of the items therein contained are true to the best of my knowledge and belief.

L. H. Quintan  
(Signature of Registrant)

Subscribed and sworn to before me this 8th day of January, 1958

My commission expires June 22, 1959

J. O. DeBrock  
(Notary Public for Oregon)

(SEAL)

**CERTIFICATE OF REGISTRATION**

STATE OF OREGON

County of Marion } ss.

This is to certify that the foregoing Registration Statement was received in the office of the State Engineer on the 11th day of January, 1958, at 1:00 o'clock P. M. and has been duly recorded in said office in Book No. 5 of Registration Statements on page 813

~~Conservation shall be established by \_\_\_\_\_ and the water completely applied to~~

~~beneficial uses \_\_\_\_\_~~

Witness my hand this 5 day of March, 1958

Lewis A. Stanley  
(State Engineer)

By \_\_\_\_\_  
(Deputy)

GR 843 C

#1530