

Registration Statement

OF CLAIMANT OF RIGHT TO APPROPRIATE GROUND WATER

TO THE STATE ENGINEER OF OREGON:

1. Edward J. Mistke
of Rt 1 Box 29 Sublimity, Oreg County of Marion
(Mailing address)

State of Oregon do hereby make application for a certificate of registration as evidence of a right to appropriate ground water.

1. Source from which water is withdrawn is pump
(Flowing well, pump well, infiltration trench, or tunnel)

2. Location is: one and one half miles north east Sublimity
(Approximate distance and direction from nearest city or town)

and is more particularly described as follows:

(a) 350 feet east and 100 feet north from S 1/4 corner Section 26
(Give distance and bearing to corner of section or other legal subdivision)

being within SW 1/4 of SE 1/4 of Sec. 26, Twp. 8 S Rge. 1 W
(Smallest legal subdivision) (N. or S.) (E. or W.)

or (b) within limits of recorded platted property, town or city:

in Lot _____, Block _____ of _____
(Name of plat or addition)

County of _____
(If within city or town, give name)

3. Construction Work was begun on Feb 1951; was completed on May 1951
(Date) (Date)

and the ground water claimed was first used for the purposes set out below on July 1 1951
(Date)

since which time the water has been used intermittently
(Continuously or Intermittently)

from May 5 1951 to Oct 15 1957
(Date) (Date)

4. Quantity of water claimed and used is 400 gallons per minute; _____ acre feet per year.

5. Purpose or Purposes for which water is used Irrigating
(Domestic, irrigation, municipal, manufacturing, industrial, etc.)

6. Description of Well: Depth 380 feet. Type Drilled
(Dug or drilled)

diameter 8 inches. Elevation of ground at well site 580 feet, mean sea level.
(As near as known)

Depth to water table 77 feet.

7. Capacity of Well: 500 g.p.m. with 49 ft feet drawdown.
_____ g.p.m. with _____ feet drawdown.

Date of test May 1951

If Flowing Well: Measured discharge _____ g.p.m. on _____
(Date)

Shut-in pressure at ground surface _____ lbs. per sq. in. on _____
(Date)

Water is controlled by _____
(Cap, valve, etc.)

8. Casing: (Give diameter, commercial specifications and depth below ground surface of each casing size.)

8 inch diameter *Steel casing* from 0 to 100 feet
 inch diameter from to feet
 inch diameter from to feet
 inch diameter from to feet

Describe and show depth of shoe, plug, adapter, liner or other details:

9. Perforated Casings or Screens:

opened end from to 100
(Number per foot and size of perforations, or describe screen)
 from to
 from to
 from to

10. Log of Well: (Describe each stratum or formation clearly, indicate if water bearing, and give thickness and depth as indicated.)

| MATERIAL | Thickness (Feet) | Depth to Bottom (Feet) |
|----------|------------------|------------------------|
| | | |
| | | |
| | | |
| | | |
| | | |
| | | |
| | | |
| | | |
| | | |
| | | |
| | | |
| | | |
| | | |
| | | |
| | | |
| | | |
| | | |
| | | |
| | | |
| | | |
| | | |

If log of well is not available, give name and address of driller.

11. Infiltration Trench: Covered or open

Dimensions: Length ft. Minimum depth ft. Maximum depth ft.

Bottom width ft. Discharge g.p.m. Date of test

12. Tunnel: Type of lining

Dimensions:
(Length, course, and cross sectional size)

Position of water bearing stratum with reference to portal of tunnel

Log of tunnel: (Preceding table for log of well may be used, if desired. Give footage from portal and character of materials, as pertinent.)

13. Pumping Equipment:

(a) Pump *Turbine 6"* Capacity *600* g.p.m.
(Make, type and size)

(b) Motor *20 H.P. Electric*
(Type and horsepower)

14. Location of area irrigated or to be irrigated, or place of use if for purposes other than irrigation.

| Township North or South | Range E. or W. of Willamette Meridian | Section | Forty-acre Tract | Number Acres To Be Irrigated | Date of Reclamation |
|-------------------------|---------------------------------------|---------|--|------------------------------|---------------------|
| 8S | 1W | 26 | NW ¹ / ₄ of SE ¹ / ₄ | 16 | July 1, 1951 |
| " | " | " | NE ¹ / ₄ of SE ¹ / ₄ | 4 | " |
| " | " | " | SW ¹ / ₄ of SE ¹ / ₄ | 40 | " |
| " | " | " | SE ¹ / ₄ of SE ¹ / ₄ | 10 | " |
| " | " | 35 | NW ¹ / ₄ of NE ¹ / ₄ | 40 | " |
| " | " | " | NE ¹ / ₄ of NE ¹ / ₄ | 10 | " |
| " | " | " | SW ¹ / ₄ of NE ¹ / ₄ | 34 | " |
| " | " | " | SE ¹ / ₄ of NE ¹ / ₄ | 6 | " |
| | | | | <u>160 Ac</u> | |

15. If the ground water supply is supplemental to an existing water supply, identification of any application for a permit, permit, certificate or adjudicated right to appropriate water made or held by the registrant.

Township 2 S Range 1 W W.M.
North

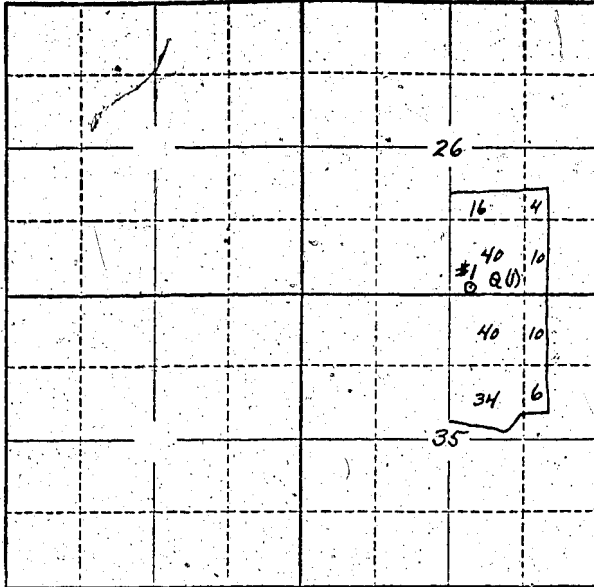

Locate well and acreage of irrigated land on plat.
Scale: 2" = 1 Mile

STATE OF OREGON

County of Marion } ss.

I, Edward J. Miotke, being first duly sworn, do hereby certify that I have read the foregoing Registration Statement and that all of the items therein contained are true to the best of my knowledge and belief.

Edward J. Miotke
(Signature of Registrant)

Subscribed and sworn to before me this 14th day of January, 1958

My commission expires June 12th, 1961

Wm. S. Bartholomew
(Notary Public)

(SEAL)

CERTIFICATE OF REGISTRATION

STATE OF OREGON

County of Marion } ss.

This is to certify that the foregoing Registration Statement was received in the office of the State Engineer on the 11 day of January, 1958, at 11 o'clock A.M. and has been duly recorded in said office in Book No. 5 of Registration Statements on page 55

Witness my hand this 24 day of April, 1958

Alvin C. Stank
(State Engineer)

By _____ (Deputy)

GR - 855 C