

# Registration Statement

## OF CLAIMANT OF RIGHT TO APPROPRIATE GROUND WATER

TO THE STATE ENGINEER OF OREGON:

I, Lester J. Pearmine and Viola Mae Pearmine  
of Route 1 Box 50 Seaside County of Clatsop  
(Mailing address)

State of Oregon, do hereby make application for a certificate of registration as evidence of a right to appropriate ground water.

1. Source from which water is withdrawn is pump well #1  
(Flowing well, pump well, infiltration trench, or tunnel)

2. Location is: 5 miles west of Seaside  
(Approximate distance and direction from nearest city or town)

and is more particularly described as follows:

(a) 11 00' West and 400 feet North from SE corner of Section 25  
(Give distance and bearing to corner of section or other legal subdivision)

being within SE 1/4 of SE 1/4 of Sec. 25, Twp. 5 S, Rge. 3 W  
(Smallest legal subdivision) (N. or S.) (E. or W.)

or (b) within limits of recorded platted property, town or city:

in Lot \_\_\_\_\_ Block \_\_\_\_\_ of \_\_\_\_\_  
(Name of plat or addition)

County of \_\_\_\_\_  
(If within city or town, give name)

3. Construction Work was begun on Oct. 10, 1951; was completed on Nov. 15, 1951  
(Date) (Date)

and the ground water claimed was first used for the purposes set out below on June 1952  
(Date)

since which time the water has been used intermittently during season  
(Continuously or intermittently)

from June 1952 to Oct. 1957  
(Date) (Date)

4. Quantity of water claimed and used is 400 gallons per minute; \_\_\_\_\_ acre feet per year.

5. Purpose or Purposes for which water is used irrigation of garden and

(Domestic, irrigation, municipal, manufacturing, industrial, etc.)

6. Description of Well: Depth 29 feet. Type drilled  
(Dug or drilled)

diameter 12 inches. Elevation of ground at well site 102 feet, mean sea level.  
(As near as known)

Depth to water table 15 feet.

7. Capacity of Well: 400 g.p.m. with 2.5 feet drawdown.

\_\_\_\_\_ g.p.m. with \_\_\_\_\_ feet drawdown.

Date of test \_\_\_\_\_

If Flowing Well: Measured discharge \_\_\_\_\_ g.p.m. on \_\_\_\_\_  
(Date)

Shut-in pressure at ground surface \_\_\_\_\_ lbs. per sq. in. on \_\_\_\_\_  
(Date)

Water is controlled by \_\_\_\_\_  
(Cap, valve, etc.)

8. **Casing:** (Give diameter, commercial specifications and depth below ground surface of each casing size.)

12 inch diameter steel casing from 0 to 59 feet  
 inch diameter from to feet  
 inch diameter from to feet  
 inch diameter from to feet

Describe and show depth of shoe, plug, adapter, liner or other details:

9. **Perforated Casings or Screens:**

unk. from to  
 (Number per foot and size of perforations, or describe screen)  
 from to  
 from to  
 from to

10. **Log of Well:** (Describe each stratum or formation clearly, indicate if water bearing, and give thickness and depth as indicated.)

MATERIAL	Thickness (Feet)	Depth to Bottom (Feet)
<u>unk.</u>		

If log of well is not available, give name and address of driller. H. J. Lavis

11. Infiltration Trench: Covered or open .....

Dimensions: Length ..... ft. Minimum depth ..... ft. Maximum depth ..... ft.  
Bottom width ..... ft. Discharge ..... g.p.m. Date of test .....

12. Tunnel: Type of lining .....

Dimensions: .....  
(Length, course, and cross sectional size)  
Position of water bearing stratum with reference to portal of tunnel .....

Log of tunnel: (Preceding table for log of well may be used, if desired. Give footage from portal and character of materials, as pertinent.)

13. Pumping Equipment:

(a) Pump Gearless 20 hp Turbine Capacity 500 g.p.m.  
(Make, type and size)  
(b) Motor 20HP Electric  
(Type and horsepower)

14. Location of area irrigated or to be irrigated, or place of use if for purposes other than irrigation.

Township North or South	Range E. or W. of Willamette Meridian	Section	Forty-acre Tract	Number Acres To Be Irrigated	Date of Reclamation
55	3W	25		<del>50</del> 80	June 1952
"	"	"	SE $\frac{1}{4}$ + SE $\frac{1}{4}$	38	" "
"	"	"	NE $\frac{1}{4}$ + SE $\frac{1}{4}$	12	" "
"	2W	30	SW $\frac{1}{4}$ + SW $\frac{1}{4}$	19	" "
"	2W	30	NW $\frac{1}{4}$ + SW $\frac{1}{4}$	4	" "
				73	

15. If the ground water supply is supplemental to an existing water supply, identification of any application for a permit, permit, certificate or adjudicated right to appropriate water made or held by the registrant.

Tract No. 134 B

Township 55 Range 3 W, W.M.  
North

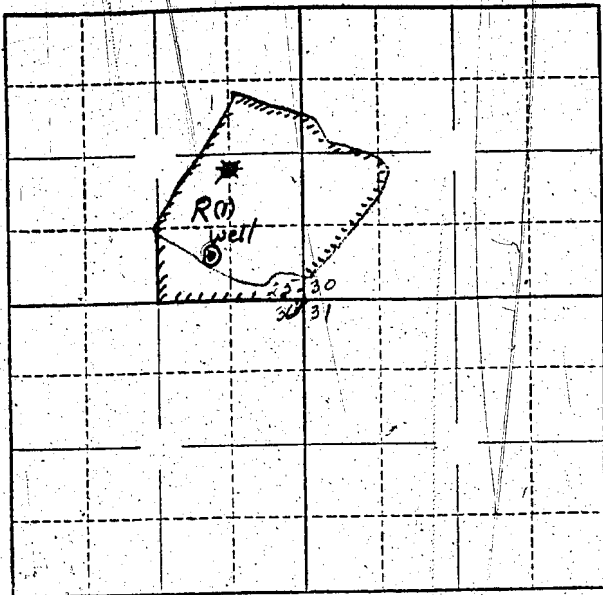

Locate well and acreage of irrigated land on plat.

Scale:  $\frac{1}{4}$ " = 1 Mile

STATE OF OREGON

County of Marion

ss.

I, Viola Ma Pearson, being first duly sworn, do hereby certify that I have read the foregoing Registration Statement and that all of the items therein contained are true to the best of my knowledge and belief.

Viola Ma Pearson  
(Signature of Registrant)

Subscribed and sworn to before me this 14th day of January, 1958.

My commission expires June 12th 1961

Wm. S. Bartholomew  
(Notary Public)

(SEAL)

**CERTIFICATE OF REGISTRATION**

STATE OF OREGON

County of Marion

ss.

This is to certify that the foregoing Registration Statement was received in the office of the State Engineer on the 14 day of January, 1958, at 12 o'clock P.M. and has been duly recorded in said office in Book No. 5 of Registration Statements on page 556.

Witness my hand this 24 day of April, 1958.

Lewis A. ...  
(State Engineer)

By

(Deputy)