

Registration Statement

OF CLAIMANT OF RIGHT TO APPROPRIATE GROUND WATER

TO THE STATE ENGINEER OF OREGON:

I, Lyle B. Thurman

of 3379 Jacksonville Highway, Medford County of Jackson

State of Oregon do hereby make application for a certificate of registration as evidence of a right to appropriate ground water.

1. Source from which water is withdrawn is Pump well #1
(Flowing well, pump well, infiltration trench, or tunnel)

2. Location is west of Medford city limits, one mile
(Approximate distance and direction from nearest city or town)

and is more particularly described as follows:

(a) 130 feet South and 100 feet West from the NE corner DIC #71
(Give distance and bearing to corner of section or other legal subdivision)

being within NE 1/4 S 34 of Sec. 27, Twp. 37 S, Rge. 2
(Smallest legal subdivision) (N. or S.) (E. or W.)

or (b) within limits of recorded platted property, town or city:

in Lot _____, Block _____ of _____
(Name of plat or addition)

County of _____
(If within city or town, give name)

3. Construction Work was begun on 1922; was completed on 1922
(Date) (Date)

and the ground water claimed was first used for the purposes set out below on 1922
(Date)

since which time the water has been used continuously
(Continuously or Intermittently)

from 1922 to October 1957
(Date) (Date)

4. Quantity of water claimed and used is 10 gallons per minute; _____ acre feet per year.

5. Purpose or Purposes for which water is used irrigation

(Domestic, irrigation, municipal, manufacturing, industrial, etc.)

6. Description of Well: Depth 62 feet. Type Dug
(Dug or drilled)

diameter 50 inches. Elevation of ground at well site 1180 feet, mean sea level.
(As near as known)

Depth to water table _____ feet.

7. Capacity of Well: 10 g.p.m. with 0 feet drawdown.

_____ g.p.m. with _____ feet drawdown.

Date of test None-noted prior use

If Flowing Well? Measured discharge _____ g.p.m. on _____
(Date)

Shut-in pressure at ground surface _____ lbs. per sq. in. on _____
(Date)

Water is controlled by _____
(Cap, valve, etc.)

8. Casing: (Give diameter, commercial specifications and depth below ground surface of each casing size.)

50 inch diameter Brick from 0 to 22 (est) feet
 inch diameter from to feet
 inch diameter from to feet
 inch diameter from to feet

Describe and show depth of shoe, plug, adapter, liner or other details:

9. Perforated Casings or Screens:

None from to
(Number per foot and size of perforations, or describe screen)
 from to
 from to
 from to

10. Log of Well: (Describe each stratum or formation clearly, indicate if water bearing, and give thickness and depth as indicated.)

MATERIAL	Thickness (Feet)	Depth to Bottom (Feet)
not known		

If log of well is not available, give name and address of driller. not known

11. Infiltration Trench: Covered or open

Dimensions: Length ft. Minimum depth ft. Maximum depth ft.

Bottom width ft. Discharge m. Date of test

12. Tunnel: Type of lining

Dimensions:
(Length, course, and cross sectional size)

Position of water bearing stratum with reference to portal of tunnel

Log of tunnel: (Preceding table for log of well may be used, if desired. Give footage from portal and character of materials, as pertinent.)

13. Pumping Equipment:

(a) Pump 2"x1.5" centrifugal pump (Jacuzzi) Capacity 40 g.p.m.
(Make, type and size)

(b) Motor 1.0 HP electric motor
(Type and horsepower)

14. Location of area irrigated or to be irrigated, or place of use if for purposes other than irrigation.

Township North or South	Range E. or W. of Willamette Meridian	Section	Forty-acre Tract	Number Acres To Be Irrigated	Date of Reclamation
37S	2N	27	NE, NW, SE ₄	0.87 <small>acres</small>	1932

15. If the ground water supply is supplemental to an existing water supply, identification of any application for a permit, permit, certificate or adjudicated right to appropriate water made or held by the registrant.
none

Township 37.S Range 2.W W.M.
North

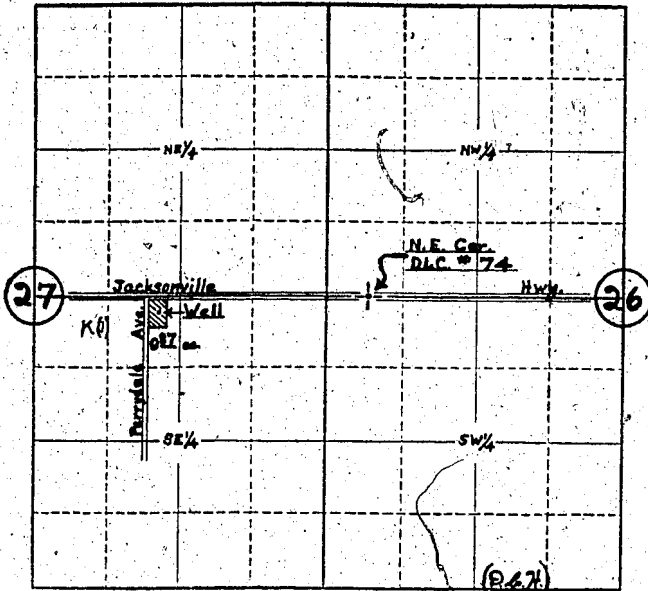

Locate well and acreage of irrigated land on plat.

Scale: 4" = 1 Mile

STATE OF OREGON

County of Jackson

} ss.

I, LYLE B. THURMAN, being first duly sworn, do hereby certify that I have read the foregoing Registration Statement and that all of the items therein contained are true to the best of my knowledge and belief.

Lyle B. Thurman
(Signature of Registrant)

Subscribed and sworn to before me this 13th day of JANUARY, 1958

My commission expires Sept. 14, 1959

Bliss H. ...
(Notary Public)

(SEAL)

CERTIFICATE OF REGISTRATION

STATE OF OREGON

County of Marion

} ss.

This is to certify that the foregoing Registration Statement was received in the office of the State Engineer on the ... day of ... 1958, at ... o'clock ... M. and has been duly recorded in said office in Book No. ... of Registration Statements on page ...

Witness my hand this 24 day of April, 1958.

Bliss H. ...
(State Engineer)

By _____ (Deputy)