

Registration Statement

OF CLAIMANT OF RIGHT TO APPROPRIATE GROUND WATER

(Under Chapter 708, Oregon Laws 1955.)

TO THE STATE ENGINEER OF OREGON:

I, John A. Moran
of 925 Dearborn Avenue, Salem, Oregon County of Marion
State of Oregon

do hereby make application for a certificate of registration as evidence of a right to appropriate ground water.

1. Source from which water is withdrawn is Pump Well
(Flowing well, pump well, infiltration trench, or tunnel)

2. Location is: One Mile South of Hoodburn, Oregon
(Approximate distance and direction from nearest city or town)

and is more particularly described as follows:

(a) As per attached plat showing 750 feet east + 300 feet south from W 1/4 corner Sec 1
(Give distance and bearing to corner of section or other legal subdivision)

being within NW 1/4 of SW 1/4 of Sec. 18, Twp. 6S, Rge. 1
(Smallest legal subdivision) (N. or S.) (E. or W.)

or (b) within limits of recorded platted property, town or city:

in Lot _____ Block _____ of _____
(Name of plat or addition)

County of _____
(If within city or town, give name)

3. Construction Work was begun on April 10, 1917; was completed on April 17, 1917
(Date) (Date)

and the ground water claimed was first used for the purposes set out below on _____
(Date)

since which time the water has been used _____
(Continuously or intermittently)

from April 10, 1917 to April 17, 1917
(Date) (Date)

4. Quantity of water claimed and used is 120 gallons per minute; _____ acre
feet per year.

5. Purpose or Purposes for which water is used _____
(Domestic, irrigation, municipal, manufacturing, industrial, etc.)

6. Description of Well: Depth 127 feet. Type _____
(Dug or drilled)

diameter 17 inches. Elevation of ground at well site 7 feet, mean sea level.
(As near as known)

Depth to water table _____ feet.

7. Capacity of Well: _____ g.p.m. with _____ feet drawdown.

_____ g.p.m. with _____ feet drawdown.

_____ test

Flowing Well: Measured discharge _____ g.p.m. on _____ (Date)

pressure at ground surface _____ lbs. per sq. in. on _____ (Date)

water is controlled by _____
(Cap, valve, etc.)

Township 55 Range 1W, W.M.
North

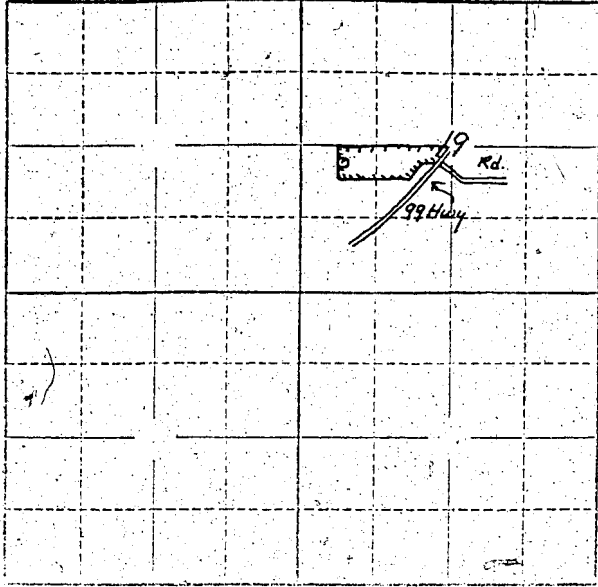

Locate well and acreage of irrigated land on plat.
Scale: 2" = 1 Mile

STATE OF OREGON
County of Marion ss.

I, _____, being first duly sworn, do hereby certify that I have read the foregoing Registration Statement and that all of the items therein contained are true to the best of my knowledge and belief.

John A. [Signature]
(Signature of Registrant)

Subscribed and sworn to before me this 17th day of January, 1958

My commission expires 12 June 1961 *Wm. S. Bartholomew*
(Notary Public)

(SEAL)

CERTIFICATE OF REGISTRATION

STATE OF OREGON }
County of Marion } ss.

This is to certify that the foregoing Registration Statement was received in the office of the State Engineer on the 17 day of January, 1958, at 2:00 o'clock P.M. and has been duly recorded in said office in Book No. 5 of Registration Statements on page 876

~~Book No. 5 of Registration Statements on page 876~~
~~Book No. 5 of Registration Statements on page 876~~

Witness my hand this 24 day of April, 1958

[Signature]
(State Engineer)

By _____
(Deputy)

GR-375 C