

Registration Statement

OF CLAIMANT OF RIGHT TO APPROPRIATE GROUND WATER

TO THE STATE ENGINEER OF OREGON:

I, BROCKNER MIKKELSEN
of 174 Wilamette Dr - Junction City, Ore County of Lane
(Mailing address)

State of _____, do hereby make application for a certificate of registration as evidence of a right to appropriate ground water.

1. Source from which water is withdrawn is PUMP WELL
(Flowing well, pump well, infiltration trench, or tunnel)

2. Location is: 1 1/2 MILES EAST OF JUNCTION CITY
(Approximate distance and direction from nearest city or town)

and is more particularly described as follows:

(a) 2497.66 FEET NORTH 20° 56' WEST OF SE COR. SEC. 33
(Give distance and bearing to corner of section or other legal subdivision)

being within NE 1/4 SE 1/4 of Sec. 33, Twp. 15 S, Rge. 4 W
(Smallest legal subdivision) (N. or S.) (E. or W.)

or (b) within limits of recorded platted property, town or city: _____

in Lot 7, Block _____ of MILLET PLAT
(Name of plat or addition)

County of LANE
(If within city or town, give name)

3. Construction Work was begun on April 1, 1952; was completed on April 2, 1952
(Date) (Date)

and the ground water claimed was first used for the purposes set out below on April 15, 1952
(Date)

since which time the water has been used Inter.
(Continuously or Intermittently)

from April 15 to Sept. 15
(Date) (Date)

4. Quantity of water claimed and used is 200 gallons per minute; 45 acre feet per year.

5. Purpose or Purposes for which water is used Irrigation

(Domestic, irrigation, municipal, manufacturing, industrial, etc.)

6. Description of Well: Depth 30 feet. Type Driven
(Dug or drilled)

diameter 4 inches. Elevation of ground at well site 325 feet, mean sea level.
(As near as known)

Depth to water table 10 feet.

7. Capacity of Well: no test g.p.m. with _____ feet drawdown.

_____ g.p.m. with _____ feet drawdown.

Date of test _____

If Flowing Well: Measured discharge _____ g.p.m. on _____
(Date)

Shut-in pressure at ground surface _____ lbs. per sq. in. on _____
(Date)

Water is controlled by _____
(Cap, valve, etc.)

8. Casing: (Give diameter, commercial specifications and depth below ground surface of each casing size.)

4 inch diameter from 0 to 30 feet
 from to feet
 from to feet
 from to feet

Describe and show depth of shoe, plug, adapter, liner or other details:

9. Perforated Casings or Screens:

Perforated from 27' to 30'
 (Number per foot and size of perforations, or describe screen)
 from to
 from to
 from to

10. Log of Well: (Describe each stratum or formation clearly, indicate if water bearing, and give thickness and depth as indicated.)

MATERIAL	Thickness (Feet)	Depth to Bottom (Feet)
<i>Sand & Gravel</i>	<i>30.</i>	<i>30</i>

If log of well is not available, give name and address of driller.

11. Infiltration Trench: Covered or open

Dimensions: Length ft. Minimum depth ft. Maximum depth ft.

Bottom width ft. Discharge g.p.m. Date of test

12. Tunnel: Type of lining

Dimensions:
(Length, course, and cross sectional size)

Position of water bearing stratum with reference to portal of tunnel

Log of tunnel: (Preceding table for log of well may be used, if desired. Give footage from portal and character of materials, as pertinent.)

13. Pumping Equipment:

(a) Pump *Cent.* Capacity *200* g.p.m.
(Make, type and size)

(b) Motor *5 hp 1 phase*
(Type and horsepower)

14. Location of area irrigated or to be irrigated, or place of use if for purposes other than irrigation.

Township North or South	Range E. or W. of Willamette Meridian	Section	Forty-acre Tract	Number Acres To Be Irrigated	Date of Reclamation
15 S	4 W	3	NE $\frac{1}{2}$ SE $\frac{1}{2}$	15.67	1952

15. If the ground water supply is supplemental to an existing water supply, identification of any application for a permit, permit, certificate or adjudicated right to appropriate water made or held by the registrant.
None

Township 15 S Range 4 W, W.M.
North

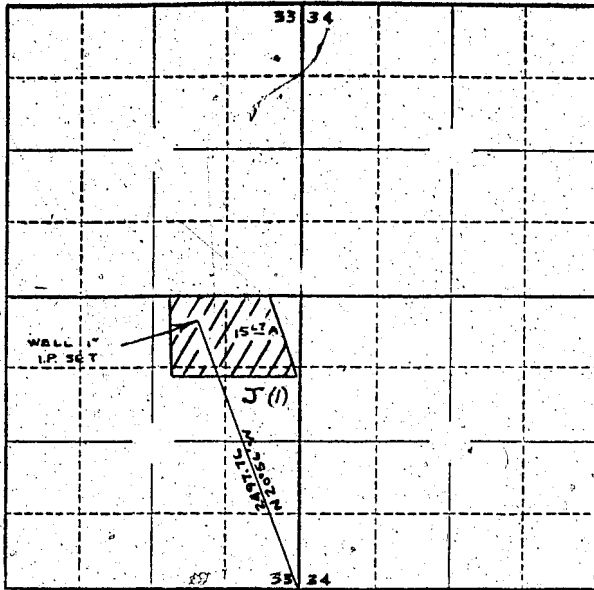

Locate well and acreage of irrigated land on plat.

Scale: 4" = 1 Mile

STATE OF OREGON

County of Marion Co. } ss.

I, _____, being first duly sworn, do hereby certify that I have read the foregoing Registration Statement and that all of the items therein contained are true to the best of my knowledge and belief.

B. rocham Mathews
(Signature of Registrant)

Subscribed and sworn to before me this 20th day of January, 1958

My commission expires 12th June 1961 Wm. S. Bartholomew
(Notary Public)

(SEAL)

CERTIFICATE OF REGISTRATION

STATE OF OREGON

County of Marion } ss.

This is to certify that the foregoing Registration Statement was received in the office of the State Engineer on the 20 day of January, 1958, at 10:00 o'clock A. M. and has been duly recorded in said office in Book No. 5 of Registration Statements on page 885.

Witness my hand this 24 day of April, 1958.

Lewis A. Stanley
(State Engineer)

By _____
(Deputy)

GR - 885 C