

Registration Statement

OF CLAIMANT OF RIGHT TO APPROPRIATE GROUND WATER

(Under Chapter 708, Oregon Laws 1955.)

TO THE STATE ENGINEER OF OREGON:

I, Jess W. Lucas and Florence Nancy Lucas

of Gervais County of Marion

State of Oregon do hereby make application for a certificate of registration as evidence of a right to appropriate ground water.

1. Source from which water is withdrawn is Pump well
(Flowing well, pump well, infiltration trench, or tunnel)

2. Location is: 5 miles West of Gervais, Oregon
(Approximate distance and direction from nearest city or town)

and is more particularly described as follows:

(a) (Give distance and bearing to corner of section or other legal subdivision)
being within S. W. 1/4 of Lot 8 of Sec. 19, Twp. 58, Rge. 2W
(Smallest legal subdivision) (N. or S.) (E. or W.)

or (b) within limits of recorded platted property, town or city:

in Lot _____, Block _____ of _____
(Name of plat or addition)
County of _____
(If within city or town, give name)

3. Construction Work was begun on July 19, 1951; was completed on July 24, 1951
(Date) (Date)

and the ground water claimed was first used for the purposes set out below on August 29, 1951
(Date)

since which time the water has been used Continuously
(Continuously or intermittently)

from August 29, 1951 to 1956
(Date) (Date)

4. Quantity of water claimed and used is 400 gallons per minute; _____ acre feet per year.

5. Purpose or Purposes for which water is used Domestic and irrigation
(Domestic, irrigation, municipal, manufacturing, industrial, etc.)

6. Description of Well: Depth 130 feet. Type Drilled
(Dug or drilled)

diameter 10 inches. Elevation of ground at well site 250 feet, mean sea level.
(As near as known)

Depth to water table 18 feet.

7. Capacity of Well: 400 g.p.m. with 125 feet drawdown.

_____ g.p.m. with _____ feet drawdown.

Date of test July 24, 1951

If Flowing Well: Measured discharge _____ g.p.m. on _____
(Date)

Shut-in pressure at ground surface _____ lbs. per sq. in. on _____
(Date)

Water is controlled by _____
(Cap, valve, etc.)

If log of well is not available, give name and address of driller.

11. Infiltration Trench: Covered or open

Dimensions: Length ft. Minimum depth ft. Maximum depth ft.

Bottom width ft. Discharge g.p.m. Date of test

12. Tunnel: Type of lining

Dimensions:
(Length, course, and cross sectional size)

Position of water bearing stratum with reference to portal of tunnel

Log of tunnel: (Preceding table for log of well may be used, if desired. Give footage from portal and character of materials, as pertinent.)

13. Pumping Equipment:

(a) Pump Turbin Capacity 400 g.p.m.
(Make, type and size)

(b) Motor 25 H. P. Electric
(Type and horsepower)

14. Location of area irrigated or to be irrigated, or place of use if for purposes other than irrigation.

Township North or South	Range E. or W. of Willamette Meridian	Section	Forty-acre tract	Number Acres To Be Irrigated	Date of Reclamation
58	2W.	19	lot 9-8-9	88	
		20	N/20E/20N.W./4	22	
		20	lot 9-8-9	22	
<u>55</u>	<u>2W</u>	<u>19</u>	<u>SE 1/4 SW 1/4</u>	<u>34</u>	<u>1951</u>
			<u>SW 1/4 SE 1/4</u>	<u>27</u>	<u>1951</u>
			<u>SE 1/4 SE 1/4</u>	<u>27</u>	<u>1951</u>
		<u>20</u>	<u>SW 1/4 SW 1/4</u>	<u>4</u>	<u>1951</u>
		<u>30</u>	<u>NE 1/4 NW 1/4</u>	<u>10</u>	<u>1951</u>
			<u>SE 1/4 NW 1/4</u>	<u>10</u>	<u>1951</u>
			<u>NE 1/4 SW 1/4</u>	<u>2</u>	<u>1951</u>
				<u>114</u>	

15. If the ground water supply is supplemental to an existing water supply, identification of any application for a permit, permit, certificate or adjudicated right to appropriate water made or held by the registrant.

Township 5 S Range 2 W, W.M.
North

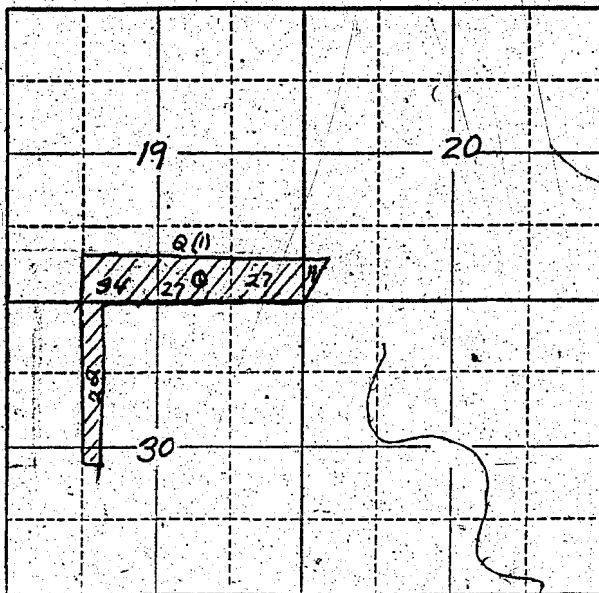

Locate well and acreage of irrigated land on plat.

Scale: 2" = 1 Mile

STATE OF OREGON

County of Marion

SS.

I, Florence Nancy Lucas, being first duly sworn, do hereby certify that I have read the foregoing Registration Statement and that all of the items therein contained are true to the best of my knowledge and belief.

By Jewell Lucas Florence Nancy Lucas
by Florence Nancy Lucas
(Signature of Registrant)

Subscribed and sworn to before me this 30 day of January, 1956

My commission expires 9/27/58

Jeanie Baxter
(Notary Public)

(SEAL)

CERTIFICATE OF REGISTRATION

STATE OF OREGON

County of Marion

SS.

This is to certify that the foregoing Registration Statement was received in the office of the State Engineer on the 30 day of January, 1956, at 2:00 o'clock P. M. and has been duly recorded in said office in Book No. 1 of Registration Statements on page GR-88C.

Construction shall be completed by 15, 1956, and the water 15 completely applied to beneficial use by 19.

Witness my hand this 12th day of April, 1956

Lewis A. Stanley
(State Engineer)

By

(Deputy)

G.R. - 88 C