

Registration Statement

OF CLAIMANT OF RIGHT TO APPROPRIATE GROUND WATER

TO THE STATE ENGINEER OF OREGON:

I, Lewis Clark
of 3438 Maurona Lane, Medford, Oregon County of Jackson
(Mailing address)

State of Oregon do hereby make application for a certificate of registration as evidence of a right to appropriate ground water.

1. Source from which water is withdrawn is Infiltration trench (drip)
(Flowing well, pump well, infiltration trench, or tunnel)

2. Location is: 3.0 miles SW of Medford, Oregon
(Approximate distance and direction from nearest city or town)

and is more particularly described as follows:

(a) 3.0 miles SW of Medford, Oregon
(Give distance and bearing to corner of section or other legal subdivision)

being within NW 1/4 NW 1/4 NE 1/4 of Sec. 24, Twp. 3, Rge. 1
(Smallest legal subdivision) (N. or S.) (E. or W.)

or (b) within limits of recorded platted property, town or city:

in Lot _____, Block _____ of _____
(Name of plat or addition)
County of _____
(If within city or town, give name)

3. Construction Work was begun on 1951; was completed on _____
(Date) (Date)

and the ground water claimed was first used for the purposes set out below on _____
(Date)

since which time the water has been used _____
(Continuously or Intermittently)

from April 1, 1951 to October 1, 1951
(Date) (Date)

4. Quantity of water claimed and used is _____ gallons per minute; _____ acre feet per year.

5. Purpose or Purposes for which water is used Irrigation of agricultural land
(Domestic, irrigation, municipal, manufacturing, industrial, etc.)

6. Description of Well: Depth 12 feet. Type Dug
(Dug or drilled)

diameter 20 inches Elevation of ground at well site 1175 feet, mean sea level.
(As near as known)

Depth to water table _____ feet.

7. Capacity of Well: 225 g.p.m. with _____ feet drawdown.

_____ g.p.m. with _____ feet drawdown.

Date of test 1951 - 1952

If Flowing Well: Measured discharge _____ g.p.m. on _____
(Date)

Shut-in pressure at ground surface _____ lbs. per sq. in. on _____
(Date)

Water is controlled by _____
(Cap, valve, etc.)

Township 37 S Range 2 W, W.M.

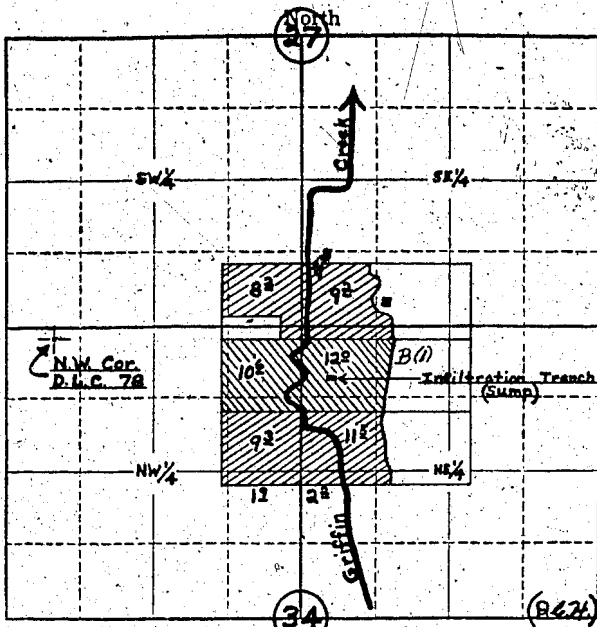

Locate well and acreage of irrigated land on plat.

Scale: 4" = 1 Mile

STATE OF OREGON

County of Washington } ss.

I, Reverie Clark, being first duly sworn, do hereby certify that I have read the foregoing Registration Statement and that all of the items therein contained are true to the best of my knowledge and belief.

Reverie Clark
(Signature of Registrant)

Subscribed and sworn to before me this 23 day of January, 1958

My commission expires Jan 23 1960 John W. [unclear]
(Notary Public)

(SEAL)

CERTIFICATE OF REGISTRATION

STATE OF OREGON

County of Marion } ss.

This is to certify that the foregoing Registration Statement was received in the office of the State Engineer on the 23 day of January, 1958, at 1:00 o'clock P. M. and has been duly recorded in said office in Book No. 5 of Registration Statements on page 901

Witness my hand this 7 day of May, 1958

Allen G. [unclear]
(State Engineer)

By _____ (Deputy)