

RECEIVED
JAN 27 1953
STATE ENGINEER
SALEM, OREGON

REGISTRATION NO. GR-93
CERTIFICATE NO. GR-89

Registration Statement

OF CLAIMANT OF RIGHT TO APPROPRIATE GROUND WATER

(Under Chapter 703, Oregon Laws 1955.)

TO THE STATE ENGINEER OF OREGON:

I, Philip and Amelia Roth

of Rt. 1, Box 359, Albany County of Linn

State of Oregon, do hereby make application for a certificate of registration as evidence of a right to appropriate ground water.

1. Source from which water is withdrawn is Pump well #1
(Flowing well, pump well, infiltration trench, or tunnel)

2. Location is: 7 miles SE of Albany, Oregon
(Approximate distance and direction from nearest city or town)

and is more particularly described as follows:

(a) N. 29 $\frac{1}{2}$ ° E. 15.5 chains from the NE corner of the Luke Hall DLC 66
(Give distance and bearing to corner of section or other legal subdivision)

being within NW $\frac{1}{4}$ of NW $\frac{1}{4}$ of Sec. 36, Twp. 11 S, Rge. 3 W
(Smallest legal subdivision) (N. or S.) (E. or W.)

or (b) within limits of recorded platted property, town or city:

in Lot _____, Block _____ of _____
(Name of plat or addition)

County of Linn
(If within city or town, give name)

3. Construction Work was begun on Sept. 30, 1952; was completed on Oct. 11, 1952
(Date) (Date)

and the ground water claimed was first used for the purposes set out below on May 17, 1953
(Date)

since which time the water has been used continuously
(Continuously or intermittently)

from May 17, 1953 to present time
(Date) (Date)

4. Quantity of water claimed and used is 105 gallons per minute; 70 acre feet per year.

5. Purpose or Purposes for which water is used Irrigation

(Domestic, irrigation, municipal, manufacturing, industrial, etc.)

6. Description of Well: Depth 135 feet. Type drilled

(Dug or drilled)

diameter 8 inches. Elevation of ground at well site 278 feet, mean sea level.
(As near as known)

Depth to water table 11 feet.

7. Capacity of Well: 260 g.p.m. with 100 feet drawdown.

110 g.p.m. with 57 feet drawdown.

Date of test Oct. 11, 1952

If Flowing Well: Measured discharge _____ g.p.m. on _____

(Date)

Shut-in pressure at ground surface _____ lbs. per sq. in. on _____

(Date)

Water is controlled by _____

(Cap, valve, etc.)

8. Casing: (Give diameter, commercial specifications and depth below ground surface of each casing size.)

8 inch diameter Plain end, welded pipe from 0 to 120 $\frac{1}{2}$ feet
 inch diameter from to feet
 inch diameter from to feet
 inch diameter from to feet

Describe and show depth of shoe, plug, adapter, liner or other details:

.....

9. Perforated Casings or Screens:

Slit perforated with torch from 102 $\frac{1}{2}$ to 120 $\frac{1}{2}$
(Number per foot and size of perforations, or describe screen)
 from to
 from to
 from to

10. Log of Well: (Describe each stratum or formation clearly, indicate if water bearing, and give thickness and depth as indicated.)

MATERIAL	Thickness (Feet)	Depth to Bottom (Feet)
Clay (light)	10	10
Gravel & clay	45	55
Sand & gravel	12	67
Clay (dark)	10	77
Gravel & clay	22 19	96
Clay	6	102
Gravel & clay	12	114
Gravel (good)	5	119
Clay	16	135

If log of well is not available, give name and address of driller.....

11. Infiltration Trench: Covered or open.....

Dimensions: Length..... ft. Minimum depth..... ft. Maximum depth..... ft.

Bottom width..... ft. Discharge..... g.p.m. Date of test.....

12. Tunnel: Type of lining.....

Dimensions:.....
(Length, course, and cross sectional size)

Position of water bearing stratum with reference to portal of tunnel.....

Log of tunnel: (Preceding table for log of well may be used, if desired. Give footage from portal and character of materials, as pertinent.)

13. Pumping Equipment:

(a) Pump Berkeley turbine..... Capacity 150 g.p.m.
(Make, type and size)

(b) Motor 7½ H.P. electric.....
(Type and horsepower)

14. Location of area irrigated or to be irrigated, or place of use if for purposes other than irrigation.

Township North or South	Range E. or W. of Willamette Meridian	Section	Forty-acre Tract	Number Acres To Be Irrigated	Date of Reclamation
10 S.	3 W.	36	NW¼ of NW¼	23.0	May 17, 1953
10 S.	3 W.	36	NE¼ of NW¼	5.0	May 17, 1953
				28.0	

~~Roth-151-237~~
Beginning at the Southeast corner of the Northeast quarter of Section 36 in T. 11 S., R 3 W. of the Will. Mer. in Linn County, Oregon; and running thence North along the East line of said section to the South line of the right-of-way of the Lebanon Branch of the O & C Railroad Co.; thence Northwesterly along the South line of said right-of-way to the West line of the Northeast quarter of said section; thence South along the West line of said Northeast quarter to the center of said section; thence East 40 chains to the place of beginning Also: Beginning at the Northwest corner of Section 36 in T. 11 S., R 3 W. of the Will. Mer.; and running thence East on the North line of said Section 12.78 chains to the center of the right-of-way of the Lebanon Branch of the O & C Railroad Co.; thence S. 65°30' E. along the center of said right-of-way 29.85 chains to the centerline of said section; thence South along the centerline of said section to a point that is 65 rods North of the center of said section; thence West 160 rods to the West line of said section; thence North 95 rods to the place of beginning containing 80 acres, more or less and containing in the aggregate of 151.48 acres, more or less; also the North half of the North half of Section 26, T. 11 S., R 3 W. of the Will. Mer. in Linn County, Oregon.

15. If the ground water supply is supplemental to an existing water supply, identification of any application for a permit, permit, certificate or adjudicated right to appropriate water made or held by the registrant.

Township 11.3 Range 34 W.M.

North

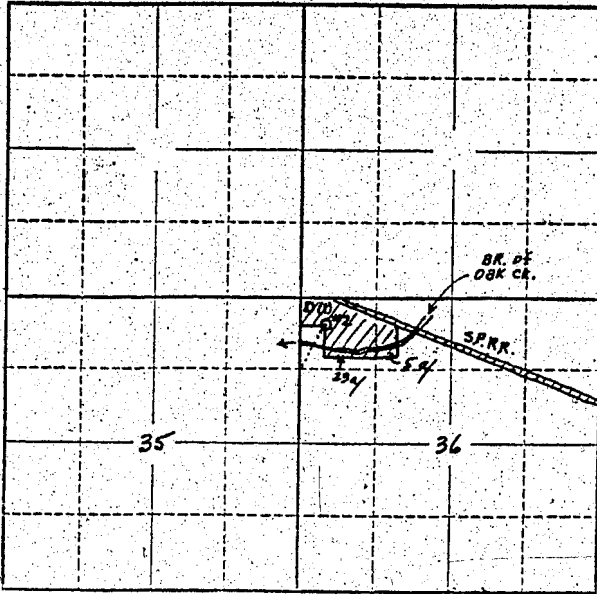

Locate well and acreage of irrigated land on plat.

Scale: 2" = 1 Mile

STATE OF OREGON

County of Linn } ss.

I, Philip and Amelia Roth, being first duly sworn, do hereby certify that I have read the foregoing Registration Statement and that all of the items therein contained are true to the best of my knowledge and belief.

Philip Roth

Amelia Roth

(Signature of Registrant)

Subscribed and sworn to before me this 25th day of January, 1956

My commission expires _____

[Signature]
(SEAL) County Clerk

CERTIFICATE OF REGISTRATION

STATE OF OREGON

County of Marion } ss.

This is to certify that the foregoing Registration Statement was received in the office of the State Engineer on the 27th day of January, 1956, at 8:00 o'clock A.M. and has been duly recorded in said office in Book No. 1 of Registration Statements on page GR-89C.

Construction shall be completed by _____, 1956, and the water completely applied to beneficial use by _____, 1956.

Witness my hand this 12th day of April, 1956.

Lewis A. Stanley

(State Engineer)

By _____ (Deputy)