

Registration Statement

RECEIVED
JUN 30 1958

STATE ENGINEER
SALEM, OREGON

CLAIMANT OF RIGHT TO APPROPRIATE GROUND WATER

TO THE STATE ENGINEER OF OREGON:

I, Douglas F. Hibler

of Rt. 5, Box 366, Eugene County of Lane
(Mailing address)

State of Oregon, do hereby make application for a certificate of registration as evidence of a right to appropriate ground water.

1. Source from which water is withdrawn is PUMP Well
(Flowing well, pump well, infiltration trench, or tunnel)

2. Location is: 7 miles SW of Eugene
(Approximate distance and direction from nearest city or town)

and is more particularly described as follows:

(a) 1850' N 6° W from SE Cor. Sec. 11
(Give distance and bearing to corner of section or other legal subdivision)

being within NE 1/4 of SW 1/4 of Sec. 11, Twp. 18 S, Rge. 5 W
(Smallest legal subdivision) (N. or S.) (E. or W.)

or (b) within limits of recorded platted property, town or city:

in Lot _____, Block _____ of _____
(Name of plat or addition)

County of _____
(If within city or town, give name)

3. Construction Work was begun on Approx 1946; was completed on 1948
(Date) (Date)

and the ground water claimed was first used for the purposes set out below on 1948
(Date)

since which time the water has been used Continuously
(Continuously or intermittently)

from Jan 1948 to Oct 1958
(Date) (Date)

4. Quantity of water claimed and used is 200 gallons per minute; 72.60 acre feet per year.

5. Purpose or Purposes for which water is used irrigation

(Domestic, irrigation, municipal, manufacturing, industrial, etc.)

6. Description of Well: Depth 9.0 feet. Type Drilled
(Dug or drilled)

diameter 6" inches. Elevation of ground at well site 433.5 feet, mean sea level.
(As near as known)

Depth to water table 4.0 feet.

7. Capacity of Well: 5/15/57 8 hrs g.p.m. with NOUR feet drawdown.

9-13/57 1:30 For 12 Hrs. g.p.m. with NOUR feet drawdown.

Date of test 5/15/57 8 hrs 9/13/57 12 hrs

If Flowing Well: Measured discharge _____ g.p.m. on _____
(Date)

Shut-in pressure at ground surface _____ lbs. per sq. in. on _____
(Date)

Water is controlled by _____
(Cap, valve, etc.)

Township 18 S Range 5 W, W.M.
North

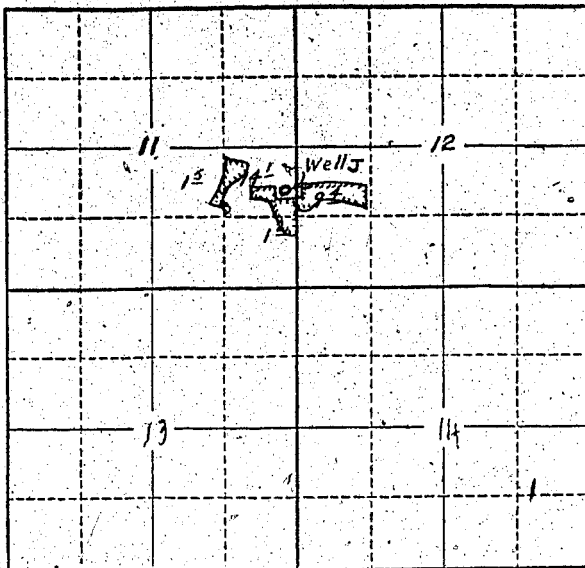

Locate well and acreage of irrigated land on plat.
Scale: 2" = 1 Mile

STATE OF OREGON

County of Lave

} ss.

I, Douglas F. Hipley, being first duly sworn, do hereby certify that I have read the foregoing Registration Statement and that all of the items therein contained are true to the best of my knowledge and belief.

Douglas F. Hipley
(Signature of Registrant)

Subscribed and sworn to before me this 23 day of Jan, 1958

My commission expires Feb 24-1960
(Notary Public)

(SEAL)

CERTIFICATE OF REGISTRATION

STATE OF OREGON

County of Marion

} ss.

This is to certify that the foregoing Registration Statement was received in the office of the State Engineer on the 27th day of January, 1958, at 8:00 o'clock A. M. and has been duly recorded in said office in Book No. 11 of Registration Statements on page GR-2442

Witness my hand this 16th day of March, 19 59

Lewis A. Blawie
(State Engineer)

By _____
(Deputy)

\$15.00