

# Registration Statement

## OF CLAIMANT OF RIGHT TO APPROPRIATE GROUND WATER

(Under Chapter 708, Oregon Laws 1955.)

TO THE STATE ENGINEER OF OREGON:

I, Twin Oaks Memorial Gardens, Inc.

of 405 W. 1st Ave. Albany County of Linn

State of Oregon, do hereby make application for a certificate of registration as evidence of a right to appropriate ground water.

1. Source from which water is withdrawn is Pump Well  
(Flowing well, pump well, infiltration trench, or tunnel)

2. Location is: Four & one-half miles Easterly from Corvallis  
(Approximate distance and direction from nearest city or town)

and is more particularly described as follows:

(a) N. 49° 34' 45" W. 5061.0 ft. From S.E. corner of Wallace Cushman D.L.C. Not. #1787  
(Give distance and bearing to corner of section or other legal subdivision) Claim #67

being within N.E. 1/4 of N.W. 1/4 of Sec. 33, Twp. 11S, Rge. 4 W. W.M.  
(Smallest legal subdivision) (N. or S.) (E. or W.)

or (b) within limits of recorded platted property, town or city:

in Lot \_\_\_\_\_, Block \_\_\_\_\_ of Twin Oaks Memorial Gardens  
(Name of plat or addition)

County of Linn  
(If within city or town, give name)

3. Construction Work was begun on 4-1-55; was completed on 4-7-55  
(Date) (Date)

and the ground water claimed was first used for the purposes set out below on 6-20-55  
(Date)

since which time the water has been used Intermittently  
(Continuously or intermittently)

from 6-20-55 to 10-1-55  
(Date) (Date)

4. Quantity of water claimed and used is Thirty gallons per minute; Two acre feet per year.

5. Purpose or Purposes for which water is used Irrigation

(Domestic, irrigation, municipal, manufacturing, industrial, etc.)

6. Description of Well: Depth 75 feet. Type Drilled  
(Dug or drilled)

diameter eight inches. Elevation of ground at well site 220 feet, mean sea level.  
(As near as known)

Depth to water table 43 feet.

7. Capacity of Well: 30 g.p.m. with 20 feet drawdown.

\_\_\_\_\_ g.p.m. with \_\_\_\_\_ feet drawdown.

Date of test 4-12-55

If Flowing Well: Measured discharge \_\_\_\_\_ g.p.m. on \_\_\_\_\_  
(Date)

Shut-in pressure at ground surface \_\_\_\_\_ lbs. per sq. in. on \_\_\_\_\_  
(Date)

Water is controlled by \_\_\_\_\_  
(Cap, valve, etc.)

8. Casing: (Give diameter, commercial specifications and depth below ground surface of each casing size.)

8 inch diameter Steel Casing from surface to 65 feet  
 inch diameter from to feet  
 inch diameter from to feet  
 inch diameter from to feet

Describe and show depth of shoe, plug, adapter, liner or other details:

9. Perforated Casings or Screens:

5 rows 1/4 x 8" slots from 52' to 64'  
 (Number per foot and size of perforations, or describe screen)  
 from to  
 from to  
 from to

10. Log of Well: (Describe each stratum or formation clearly, indicate if water bearing, and give thickness and depth as indicated.)

MATERIAL	Thickness (Feet)	Depth to Bottom (Feet)
Clay	25	25
Conglomerate, Sand, Gravel & Clay	18	43
Water bearing gravel	21	64
Blue clay		
64 ft. to 75 ft. (total depth) Pilot-hole		
Well drilled by Claude Schaeffer Philomath, Ore.		



Township 11 S Range 4 W W.M.  
North

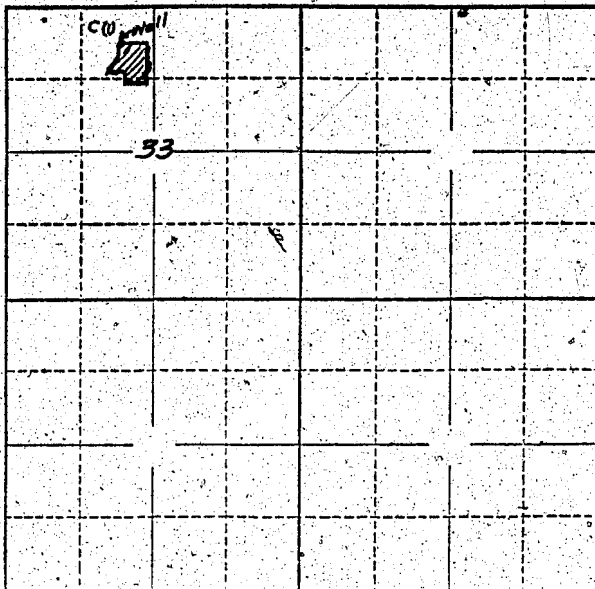

Locate well and acreage of irrigated land on plat.  
Scale: 2" = 1 Mile

STATE OF OREGON

County of Linn

ss.

I, L. Dale Emery, being first duly sworn, do hereby certify that I have read the foregoing Registration Statement and that all of the items therein contained are true to the best of my knowledge and belief.

L. Dale Emery  
For Twin Oaks Memorial Gardens

Subscribed and sworn to before me this 27th day of January, 1956

My commission expires Sept 28, 1958

Edwanda P. Gilmore  
(Notary Public)

(SEAL)

**CERTIFICATE OF REGISTRATION**

STATE OF OREGON

County of Marion

ss.

This is to certify that the foregoing Registration Statement was received in the office of the State Engineer on the 2nd day of February, 1956, at 8:00 o'clock A. M. and has been duly recorded in said office in Book No. 1 of Registration Statements on page GR-94C

~~Construction shall be completed by \_\_\_\_\_ and the costs completely applied to the fund by \_\_\_\_\_~~

Witness my hand this 12th day of April, 1956

Leura A. Stanley  
(State Engineer)

By \_\_\_\_\_  
(Deputy)