

#1 Sump

RECEIVED  
FEB 10 1958  
STATE ENGINEER  
SOUTH OREGON

Registration No. GR - 982

Certificate No. GR - 951

# Registration Statement

## OF CLAIMANT OF RIGHT TO APPROPRIATE GROUND WATER

### TO THE STATE ENGINEER OF OREGON:

I, Gilbert Knips

of 191 Oak Grove Road, Medford, County of Jackson

State of Oregon do hereby make application for a certificate of registration as evidence of a right to appropriate ground water.

1. Source from which water is withdrawn is #1 Sump  
(Flowing well, pump well, infiltration trench, or tunnel)

2. Location is: 2 miles West and South of Medford, Oregon  
(Approximate distance and direction from nearest city or town)

and is more particularly described as follows:

(a) 110 feet North and 1145 feet East from the N.W. corner LLC #77  
(Give distance and bearing to corner of section or other legal subdivision)

being within SW 1/4 SE 1/4 of Sec. 26, Twp. 37 S., Rge. 2 E.  
(Smallest legal subdivision) (N. or S.) (E. or W.)

or (b) within limits of recorded platted property, town or city:

in Lot \_\_\_\_\_, Block \_\_\_\_\_ of \_\_\_\_\_  
(Name of plat or addition)

County of \_\_\_\_\_  
(If within city or town, give name)

3. Construction Work was begun on 1948; was completed on 1948  
(Date) (Date)

and the ground water claimed was first used for the purposes set out below on 1948  
(Date)

since which time the water has been used continuously  
(Continuously or Intermittently)

from 1948 to October 1957  
(Date) (Date)

4. Quantity of water claimed and used is 60 gallons per minute; 108 acre feet per year.

5. Purpose or Purposes for which water is used irrigation and supplemental irrigation

(Domestic, irrigation, municipal, manufacturing, industrial, etc.)

See item 6. Description of Well: Depth 14 feet. Type \_\_\_\_\_  
(Dug or drilled)

diameter 140' x 25'. Elevation of ground at well site 1135 feet, mean sea level  
(As near as known)

Depth to water table 1.0 feet.

7. Capacity of Well: 60 g.p.m. with \_\_\_\_\_ feet drawdown.

g.p.m. with \_\_\_\_\_ feet drawdown

Date of test none - noted for use

If Flowing Well: Measured discharge \_\_\_\_\_ on \_\_\_\_\_  
(Date)

Shut-in pressure at ground surface \_\_\_\_\_ lbs. per sq. in. on \_\_\_\_\_  
(Date)

Water is controlled by \_\_\_\_\_  
(Cap, valve, etc.)

8. Casing: (Give diameter, commercial specifications and depth below ground surface of each casing size.)

..... inch diameter none ..... from ..... to ..... feet  
..... inch diameter ..... from ..... to ..... feet  
..... inch diameter ..... from ..... to ..... feet  
..... inch diameter ..... from ..... to ..... feet

Describe and show depth of shoe, plug, adapter, liner or other details:  
.....  
.....

9. Perforated Casings or Screens:

none ..... from ..... to .....  
(Number per foot and size of perforations, or describe screen)  
..... from ..... to .....  
..... from ..... to .....  
..... from ..... to .....

10. Log of Well: (Describe each stratum or formation clearly, indicate if water bearing, and give thickness and depth as indicated.)

MATERIAL	Thickness (Feet)	Depth to Bottom (Feet)
Black loam soil	2	0
Large gravel (water bearing)	1	0
Clay and medium gravel (water bearing)	9	0

If log of well is not available, give name and address of driller. ....

11. Infiltration Trench: Covered or open open.....

Dimensions: Length 120..... ft. Minimum depth 10..... ft. Maximum depth 12..... ft.

Bottom width 25..... ft. Discharge ..... g.p.m. Date of test none.....

12. Tunnel: Type of lining .....

Dimensions: .....  
(Length, course, and cross sectional size)

Position of water bearing stratum with reference to portal of tunnel .....

Log of tunnel: (Preceding table for log of well may be used, if desired. Give footage from portal and character of materials, as pertinent.)

13. Pumping Equipment:

(a) Pump 1 1/2" x 1 1/2" centrifugal pump (Pacific)..... Capacity ..... g.p.m.  
(Make, type and size)

(b) Motor 2.0 H.P. electric motor.....  
(Type and horsepower)

14. Location of area irrigated or to be irrigated, or place of use if for purposes other than irrigation.

Township North or South	Range E. or W. of Williamsite Meridian	Section	Forty-acre Tract	Number Acres To Be Irrigated	Date of Reclamation
37 S.	2 W.	26	SE 1/4 SW 1/4	16.6	1948
			W 1/2 SW 1/4 SE 1/4	7.7	1940
			Total	44.3	

15. If the ground water supply is supplemental to an existing water supply, identification of any application for a permit, permit, certificate or adjudicated right to appropriate water made or held by the registrant.  
I receive water from the Medford Irrigation District on approximately the West 5 acres.

Township 37 S. Range 2 W., W.M.

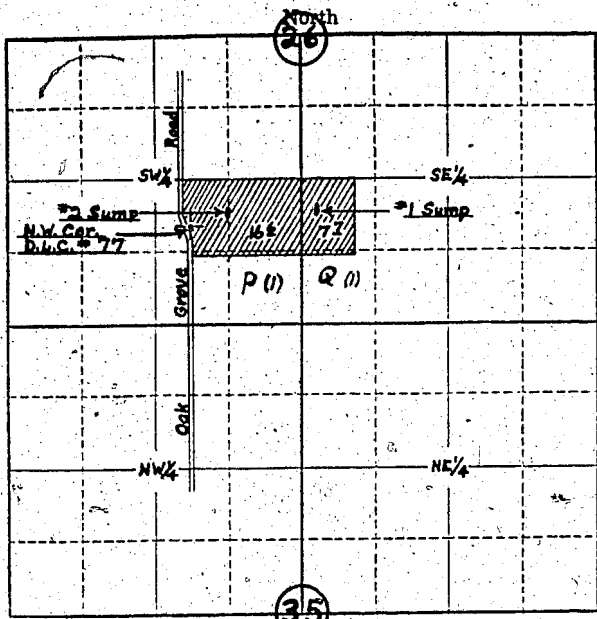

Locate well and acreage of irrigated land on plat.

Scale: 4" = 1 Mile

STATE OF OREGON

County of Jackson } ss.

I, Gilbert G. Knips, being first duly sworn, do hereby certify that I have read the foregoing Registration Statement and that all of the items therein contained are true to the best of my knowledge and belief.

(Signature of Registrant)

Subscribed and sworn to before me this 7th day of February, 1958.

My commission expires August 25, 1958.

(Notary Public)

(SEAL)

CERTIFICATE OF REGISTRATION

STATE OF OREGON

County of Marion } ss.

This is to certify that the foregoing Registration Statement was received in the office of the State Engineer on the 10th day of February, 1958, at 8:50 o'clock P.M. and has been recorded in said office in Book No. 5 of Registration Statements on page 951.

Witness my hand this 7 day of May 1958.

State Engineer Signature

(State Engineer)

By (Deputy)