

RECEIVED  
FEB 10 1958  
STATE ENGINEER  
SALEM, OREGON

Registration No. GR. - 985

Certificate No. GR. - 954

# Registration Statement

## OF CLAIMANT OF RIGHT TO APPROPRIATE GROUND WATER

TO THE STATE ENGINEER OF OREGON:

I, ORVILLE G. WILLIAMSON

of 2245 RIVER LOOP NO. 2 County of LANE  
(Mailing address)

State of OREGON, do hereby make application for a certificate of registration as evidence of a right to appropriate ground water.

1. Source from which water is withdrawn is PUMP WELL  
(Flowing well, pump well, infiltration trench, or tunnel)

2. Location is: 5 MILES N. OF EUGENE  
(Approximate distance and direction from nearest city or town)

and is more particularly described as follows:

(a) 1285 E. 1/4 700' N. OF THE SW. 1/4 OF E. 1/4 GARRET MARVIN D.C. NO. 2143  
(Give distance and bearing to corner of section or other legal subdivision)

being within SE 1/4 OF SW 1/4 of Sec. 36, Twp. 16 S, Rge. 4 W  
(Smallest legal subdivision) (N. or S.) (E. or W.)

or (b) within limits of recorded platted property, town or city:

in Lot \_\_\_\_\_ Block \_\_\_\_\_ of \_\_\_\_\_  
(Name of plat or addition)

County of \_\_\_\_\_  
(If within city or town, give name)

3. Construction Work was begun on JUNE 1943, was completed on JUNE 1943  
(Date) (Date)

and the ground water claimed was first used for the purposes set out below on JUNE 1943  
(Date)

since which time the water has been used EACH YEAR  
(Continuously or Intermittently)

from JUNE 1943 to PRESENT (OCT, 1958)  
(Date) (Date)

4. Quantity of water claimed and used is 50 gallons per minute; 17.5 acre feet per year.

5. Purpose or Purposes for which water is used IRRIGATION

(Domestic, irrigation, municipal, manufacturing, industrial, etc.)

6. Description of Well: Depth 18 feet. Type DRIVEN  
(Dug or drilled)

diameter 2-2" inches. Elevation of ground at well site 470 375 feet, mean sea level.  
(As near as known)

Depth to water table 10 feet.

7. Capacity of Well: \_\_\_\_\_ g.p.m. with \_\_\_\_\_ feet drawdown.

\_\_\_\_\_ g.p.m. with \_\_\_\_\_ feet drawdown.

Date of test \_\_\_\_\_

If Flowing Well: Measured discharge \_\_\_\_\_ g.p.m. on \_\_\_\_\_  
(Date)

Shut-in pressure at ground surface \_\_\_\_\_ lbs. per sq. in. on \_\_\_\_\_  
(Date)

Water is controlled by \_\_\_\_\_  
(Cap. valve, etc.)

8. Casing: (Give diameter, commercial specifications and depth below ground surface of each casing size.)

2 inch diameter 2" STEEL PIPES from SURFACE to 18 feet  
 inch diameter from to feet  
 inch diameter from to feet  
 inch diameter from to feet

Describe and show depth of shoe, plug, adapter, liner or other details:

THIS WELL CONSISTS OF TWO 2" DRIVEN PIPES 2' APART AND CONNECTED TOGETHER AT THE TOP.

9. Perforated Casings or Screens:

1/4" - 12 PER FOOT from 16 to 20 feet  
 (Number per foot and size of perforations, or describe screen)  
 from to  
 from to  
 from to

10. Log of Well: (Describe each stratum or formation clearly, indicate if water bearing, and give thickness and depth as indicated.)

MATERIAL	Thickness (Feet)	Depth to Bottom (Feet)
SANDY LOAM	10'	8'
SANDY GRAVEL	8'	0'

If log of well is not available, give name and address of driller: .....

11. Infiltration Trench: Covered or open .....

Dimensions: Length ..... ft. Minimum depth ..... ft. Maximum depth ..... ft.

Bottom width ..... ft. Discharge ..... g.p.m. Date of test .....

12. Tunnel: Type of lining .....

Dimensions: .....  
(Length, course, and cross sectional size)

Position of water bearing stratum with reference to portal of tunnel .....

Log of tunnel: (Preceding table for log of well may be used, if desired. Give footage from portal and character of materials, as pertinent.)

13. Pumping Equipment:

(a) Pump EMCO CENT. 2" Capacity 200 g.p.m.  
(Make, type and size)

(b) Motor ELECTRIC 10 HP  
(Type and horsepower)

14. Location of area irrigated or to be irrigated, or place of use if for purposes other than irrigation.

Township North or South	Range E. or W. of Willamette Meridian	Section	Forty-acre Tract	Number Acres To Be Irrigated	Date of Reclamation
16 S	4 W	36	SE 1/4 SW 1/4	7	JUNE 1943

15. If the ground water supply is supplemental to an existing water supply, identification of any application for a permit, permit, certificate or adjudicated right to appropriate water made or held by the registrant.

Township 26.5 Range 4 W, W.M.  
North

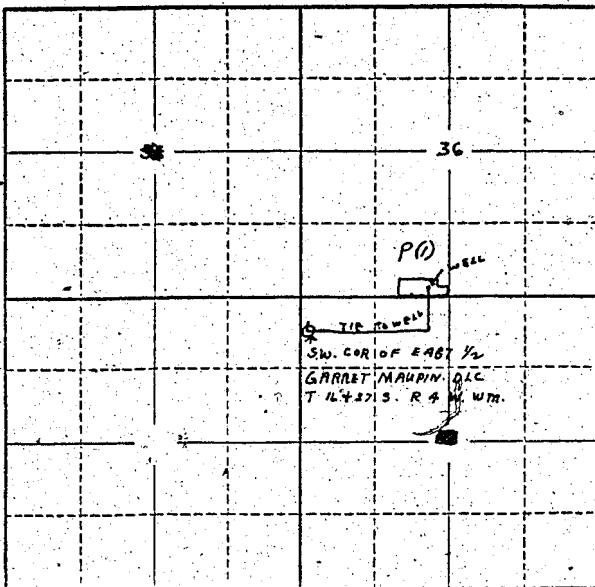

Locate well and acreage of irrigated land on plat.  
Scale: 2" = 1 Mile

STATE OF OREGON

County of Lane } ss.

I, Orville G. Williamson, being first duly sworn, do hereby certify that I have read the foregoing Registration Statement and that all of the items therein contained are true to the best of my knowledge and belief.

Orville G. Williamson  
(Signature of Registrant)

Subscribed and sworn to before me this 3rd day of February, 1958

My commission expires My Commission Expires Dec. 4, 1959 William K. Clark  
(Notary Public)

(SEAL)

**CERTIFICATE OF REGISTRATION**

STATE OF OREGON

County of Marion } ss.

This is to certify that the foregoing Registration Statement was received in the office of the State Engineer on the 10th day of February, 1958, at 8:00 o'clock A. M. and has been duly recorded in said office in Book No. 5 of Registration Statements on page 951.

Witness my hand this 28 day of May, 1958

Laura A. Stanley  
(State Engineer)

By \_\_\_\_\_ (Deputy)