

Township 10S Range 3W W.M.

North

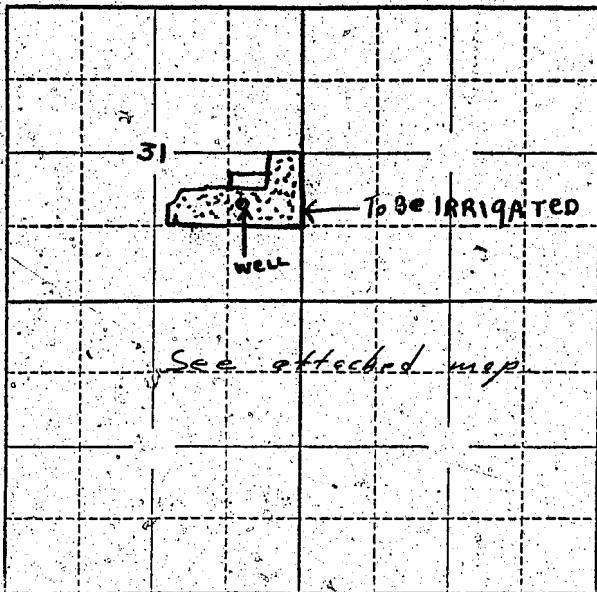

Locate well and acreage of irrigated land on plat.

Scale: 2" = 1 Mile

STATE OF OREGON

County of Linn

ss.

I, Sam & Vesta Nofziger, being first duly sworn, do hereby certify that I have read the foregoing Registration Statement and that all of the items therein contained are true to the best of my knowledge and belief.

Sam Nofziger, Vesta Nofziger (Signatures of Registrant)

Subscribed and sworn to before me this 7th day of September 1955

NOTARY PUBLIC FOR OREGON

My commission expires My Commission Expires May 28 1959

Notary Signature (Notary Public)

(SEAL)

CERTIFICATE OF REGISTRATION

STATE OF OREGON

County of Marion

ss.

This is to certify that the foregoing Registration Statement was received in the office of the State Engineer on the 11th day of September 1955, at 2:23 o'clock P.M. and has been duly recorded in said office in Book No. 1 of Registration Statements on page 9

Construction shall be completed by 1955, and the water completely applied to beneficial use by 1955

Witness my hand this 24th day of February 1956

Lewis A. Stankle (State Engineer)

By (Deputy)