

Township 6975 Range 3 W, W.M.

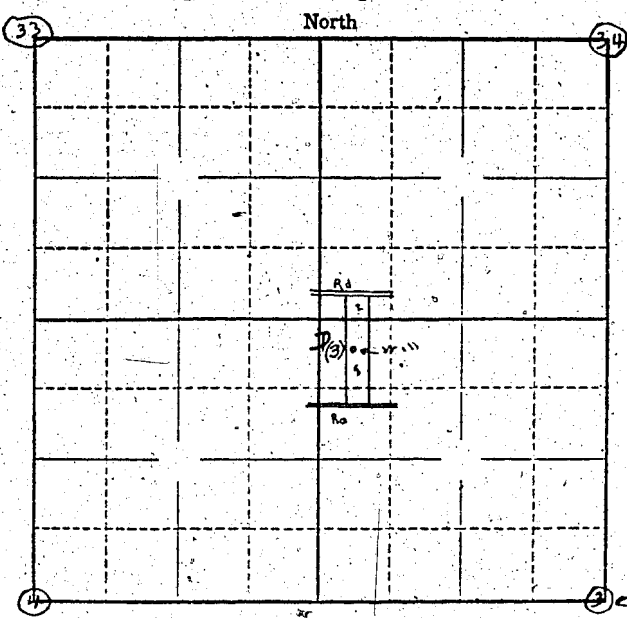

Locate well and acreage of irrigated land on plat.

Scale: 1" = 1 Mile

STATE OF OREGON

County of Marion } ss.

I, \_\_\_\_\_ being first duly sworn, do hereby certify that I have read the foregoing Registration Statement and that all of the items therein contained are true to the best of my knowledge and belief.

Alex Stain  
(Signature of Registrant)

Subscribed and sworn to before me this 21st day of February, 1958.

My commission expires 12th June 1961 Wm. S. Bartholomew  
(Notary Public)

(SEAL)

**CERTIFICATE OF REGISTRATION**

STATE OF OREGON } ss.  
County of Marion

This is to certify that the foregoing Registration Statement was received in the office of the State Engineer on the 21st day of February, 1958, at 9:30 o'clock A. M. and has been duly recorded in said office in Book No. 5 of Registration Statements on page GR-1011C

Witness my hand this 30th day of June, 1958.  
Laura J. Stanley  
(State Engineer)

By \_\_\_\_\_ (Deputy)