

North

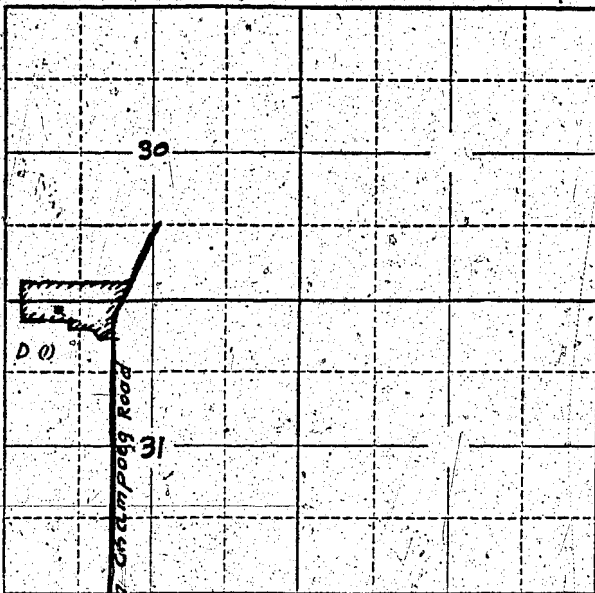

Locate well and acreage of irrigated land on plat.

Scale: 2" = 1 Mile

STATE OF OREGON

County of Marion } ss.

I, Louis Schmeber, being first duly sworn, do hereby certify that I have read the foregoing Registration Statement and that all of the items therein contained are true to the best of my knowledge and belief.

Louis Schmeber
(Signature of Registrant)

Subscribed and sworn to before me this 9th day of February, 1956.

My commission expires September 8, 1956

Max Rogers
(Notary Public)

(SEAL)

CERTIFICATE OF REGISTRATION

STATE OF OREGON

County of Marion } ss.

This is to certify that the foregoing Registration Statement was received in the office of the State Engineer on the 9th day of February, 1956, at 8:00 o'clock A.M. and has been duly recorded in said office in Book No. 1 of Registration Statements on page GR-97C

~~Construction shall be completed by _____ and the water complete application for public use by _____~~

Witness my hand this 12th day of April, 1956

Levio A. Stanley
(State Engineer)

By _____ (Deputy)