

Township 6S Range 3W, W.M.  
North

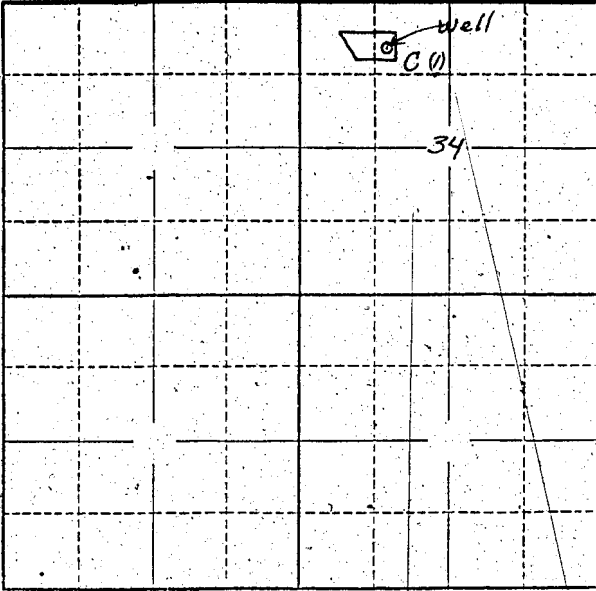

Locate well and acreage of irrigated land on plat.  
Scale: 2" = 1 Mile

STATE OF OREGON }  
County of Marion } ss.

I, \_\_\_\_\_, being first duly sworn, do hereby certify that I have read the foregoing Registration Statement and that all of the items therein contained are true to the best of my knowledge and belief.

O C Frogley O C Frogley  
(Signature of Registrant)

Subscribed and sworn to before me this 21st day of February, 1958.

My commission expires 12th June 1961. Wm. S. Bartholomew  
(Notary Public)

(SEAL)

**CERTIFICATE OF REGISTRATION**

STATE OF OREGON }  
County of Marion } ss.

This is to certify that the foregoing Registration Statement was received in the office of the State Engineer on the 21st day of February, 1958, at 9:30 o'clock A. M. and has been duly recorded in said office in Book No. 5 of Registration Statements on page GR-1015C

Witness my hand this 30th day of June, 1958.

Lewis W. Manning  
(State Engineer)

By \_\_\_\_\_ (Deputy)

\$15.00