

North

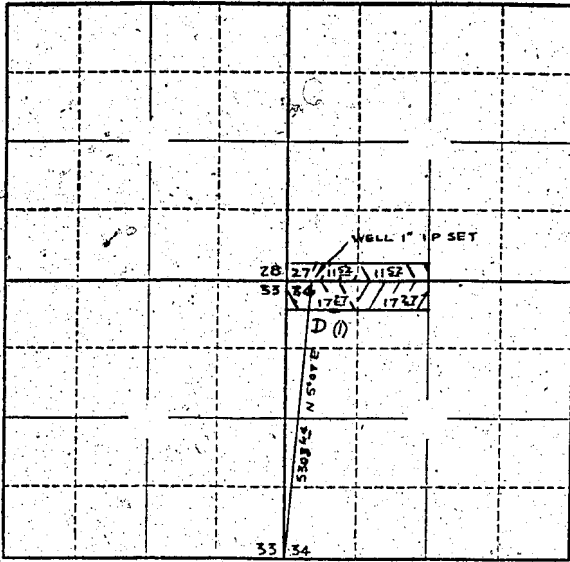

Locate well and acreage of irrigated land on plat.

Scale: 2" = 1 Mile

STATE OF OREGON

County of Lane

ss.

I, Thorvald C. Andersen, being first duly sworn, do hereby certify that I have read the foregoing Registration Statement and that all of the items therein contained are true to the best of my knowledge and belief.

Thorvald C. Andersen (Signature of Registrant)

Subscribed and sworn to before me this 12 day of February, 1958

My commission expires June 2, 1961

(Notary Public)

(SEAL)

CERTIFICATE OF REGISTRATION

STATE OF OREGON

County of Marion

ss.

This is to certify that the foregoing Registration Statement was received in the office of the State Engineer on the 12 day of March, 1958, at 10 o'clock A.M. and has been duly recorded in said office in Book-No. 6 of Registration Statements on page GR-1077

Witness my hand this 30th day of June, 1958

Laura A. Stanley (State Engineer)

By

(Deputy)