

Township 15 S Range 4 W, W.M.
North

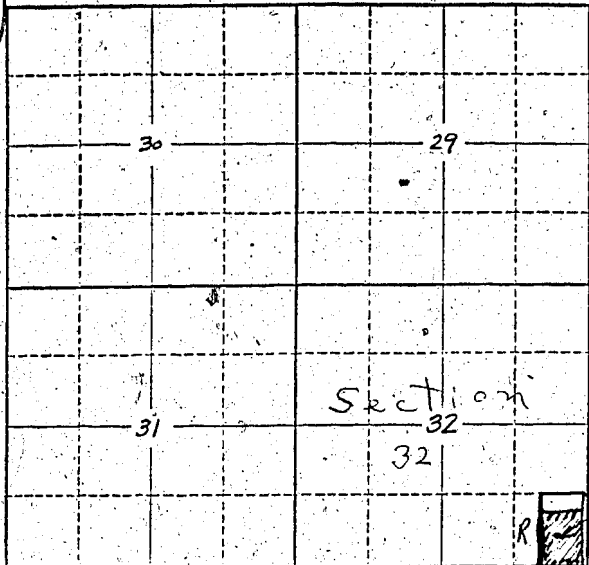

well cross hatched area irrigated.
Black dot indicates location of well.

Locate well and acreage of irrigated land on plat.
Scale: 2" = 1 Mile

STATE OF OREGON

County of Lane } ss.

I, Ejner Christiansen, being first duly sworn, do hereby certify that I have read the foregoing Registration Statement and that all of the items therein contained are true to the best of my knowledge and belief.

Ejner Christiansen
(Signature of Registrant)

Subscribed and sworn to before me this 14th day of March, 1937.

My commission expires June 25, 1931, John A. [unclear]
(Notary Public)

(SEAL)

CERTIFICATE OF REGISTRATION

STATE OF OREGON } ss.
County of Marion

This is to certify that the foregoing Registration Statement was received in the office of the State Engineer on the 11 day of March, 1937, at 1:00 o'clock P.M. and has been duly recorded in said office in Book No. 6 of Registration Statements on page GR-1318

~~to be used only when the same has been completed by the State Engineer and the work is completely approved by the State Engineer.~~

Witness my hand this 20th day of October, 1958.

[Signature]
(State Engineer)

By _____ (Deputy) GR-1318