

Plat below used as the entire area of farm

Sec 32 Township 16 S Range No 3 West 1/4 M

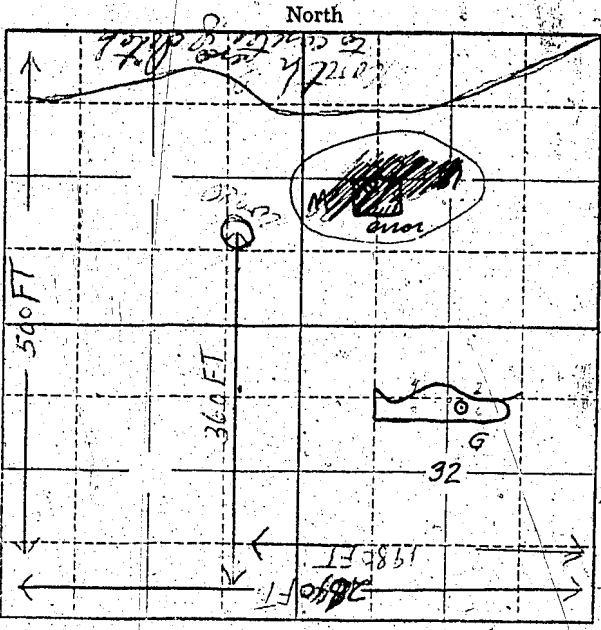

Locate well and acreage of irrigated land on plat. Scale: 2" = 1 Mile

STATE OF OREGON }
County of Lane } ss.

I, V.F. Vandemark, being first duly sworn, do hereby certify that I have read the foregoing Registration Statement and that all of the items therein contained are true to the best of my knowledge and belief.

V.F. Vandemark
(Signature of Registrant)

Subscribed and sworn to before me this 10 day of October, 1957

My commission expires 2-9-1958

[Signature]
(Notary Public)

(SEAL)

CERTIFICATE OF REGISTRATION

STATE OF OREGON }
County of Marion } ss.

This is to certify that the foregoing Registration Statement was received in the office of the State Engineer on the 21st day of March, 1958, at 8.00 o'clock A.M. and has been duly recorded in said office in Book No. 16 of Registration Statements on page GR-3788

~~By _____ and the water completely accepted or~~

Witness my hand this 20th day of November, 1959

[Signature]
(State Engineer)

\$15.00

By _____ (Deputy)

GR-3788