

North

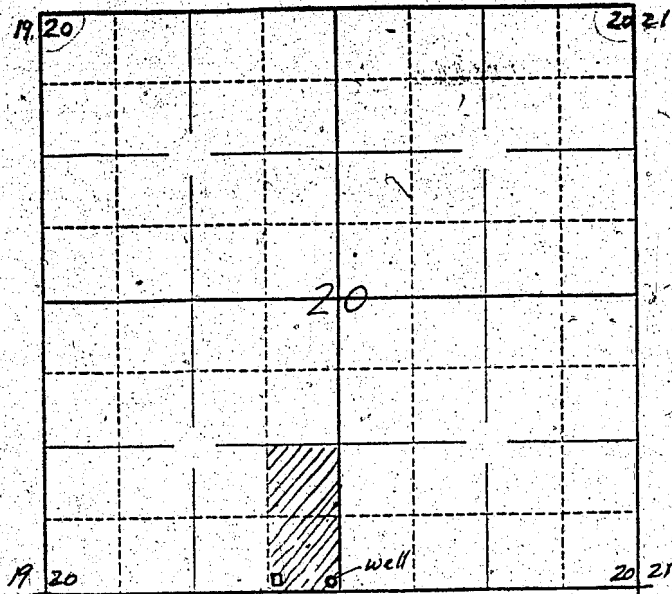

Locate well and acreage of irrigated land on plat. 29 28

Scale: 4" = 1 Mile

STATE OF OREGON

County of Wasco } ss.

I, Charles Duille Alexander, being first duly sworn, do hereby certify that I have read the foregoing Registration Statement and that all of the items therein contained are true to the best of my knowledge and belief.

Charles Duille Alexander
(Signature of Registrant)

Subscribed and sworn to before me this 6th day of March, 1958

My commission expires Sept 2 1960 Charles E. [unclear]
(Notary Public)

(SEAL)

CERTIFICATE OF REGISTRATION

STATE OF OREGON

County of Marion } ss.

This is to certify that the foregoing Registration Statement was received in the office of the State Engineer on the 26th day of March, 1958, at 11:00 o'clock P. M. and has been duly recorded in said office in Book No. 6 of Registration Statements on page GR-1227

Witness my hand this 19 day of September, 1958

Claris A. Stanley
(State Engineer)

By _____ (Deputy)