

North

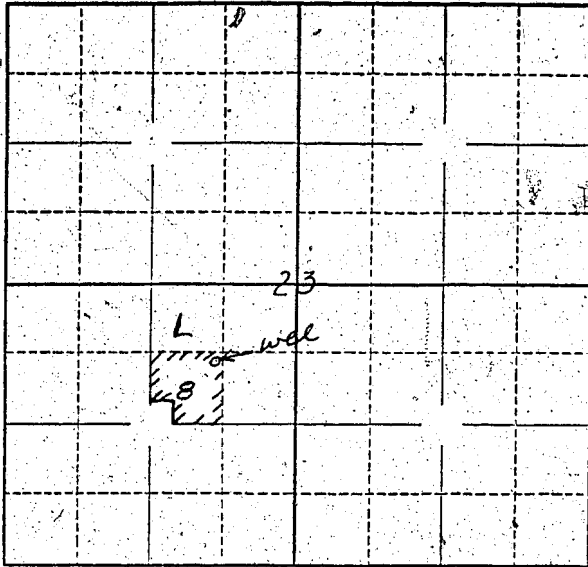

Locate well and acreage of irrigated land on plat.

Scale: 2" = 1 Mile

STATE OF OREGON

County of UMATILLA } ss.

I, Levene, being first duly sworn, do hereby certify that I have read the foregoing Registration Statement and that all of the items therein contained are true to the best of my knowledge and belief.

Levene W. Braun
(Signature of Registrant)

Subscribed and sworn to before me this 26th day of MARCH, 1954

My commission expires JUN 10 1950

(Notary Public)

(SEAL)

CERTIFICATE OF REGISTRATION

STATE OF OREGON } ss.
County of Marion

This is to certify that the foregoing Registration Statement was received in the office of the State Engineer on the 27th day of March, 1954, at 1.00 o'clock P.M. and has been duly recorded in said office in Book No. 6 of Registration Statements on page GR 1215

Witness my hand this 19 day of September, 1958

Levno A. Stanley
(State Engineer)

By _____ (Deputy)