

Township 55 Range 1W W.M.

2E 21  
North

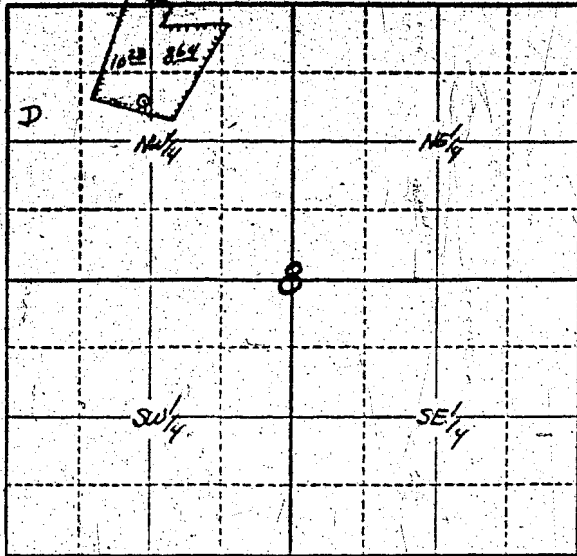

Locate well and acreage of irrigated land on plat.

Scale:  $\frac{1}{4}$ " = 1 Mile  
4"

STATE OF OREGON

County of Marion } ss.

I, \_\_\_\_\_, being first duly sworn, do hereby certify that I have read the foregoing Registration Statement and that all of the items therein contained are true to the best of my knowledge and belief.

Mrs. H. Howard Leighty  
(Signature of Registrant)

Subscribed and sworn to before me this 4th day of April, 1958

My commission expires 12th June 1961

Wm. S. Bartholomew  
(Notary Public)

(SEAL)

**CERTIFICATE OF REGISTRATION**

STATE OF OREGON

County of Marion } ss.

This is to certify that the foregoing Registration Statement was received in the office of the State Engineer on the 4th day of April, 1958, at 2:00 o'clock P. M. and has been duly recorded in said office in Book No. 6 of Registration Statements on page OR 1302

Witness my hand this 20th day of October, 1958.

Flora A. Stanley  
(State Engineer)

By \_\_\_\_\_  
(Deputy)