

North

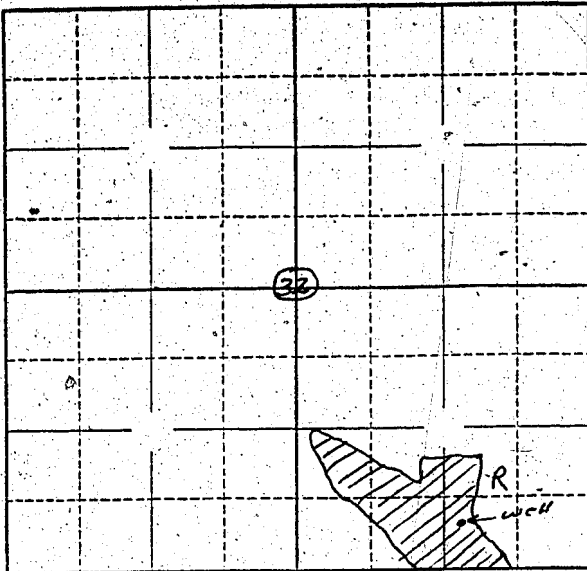

Locate well and acreage of irrigated land on plat.

Scale: 2" = 1 Mile

STATE OF OREGON

County of Marion } ss.

I, \_\_\_\_\_, being first duly sworn, do hereby certify that I have read the foregoing Registration Statement and that all of the items therein contained are true to the best of my knowledge and belief.

Ray C. Samborn  
(Signature of Registrant)

Subscribed and sworn to before me this 1st day of April, 1958

My commission expires 12th June 1961  
Wm. S. Bartholomew  
(Notary Public)

(SEAL)

**CERTIFICATE OF REGISTRATION**

STATE OF OREGON } ss.  
County of Marion

This is to certify that the foregoing Registration Statement was received in the office of the State Engineer on the 10th day of April, 1958, at 2:00 o'clock PM and has been duly recorded in said office in Book No. 7 of Registration Statements on page GR-1317

Witness my hand this 20th day of October, 1958

Levin A. Stanley  
(State Engineer)

By \_\_\_\_\_ (Deputy)