

North

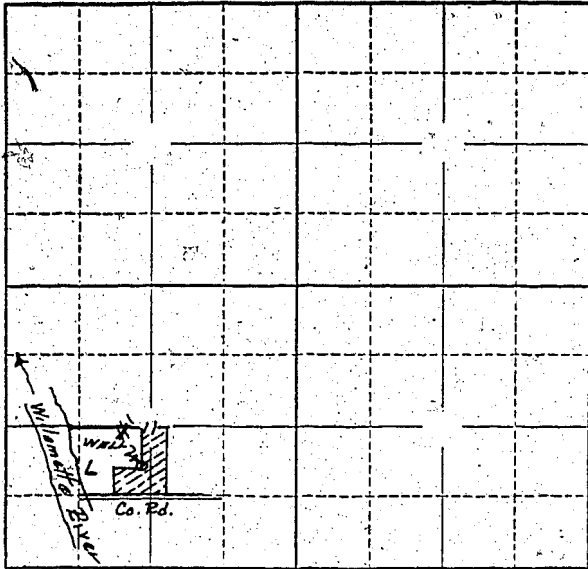

Locate well and acreage of irrigated land on plat.

Scale: 2" = 1 Mile

STATE OF OREGON

County of Lane

} ss.

I, Isom Cox, being first duly sworn, do hereby certify that I have read the foregoing Registration Statement and that all of the items therein contained are true to the best of my knowledge and belief.

Isom Cox  
(Signature of Registrant)

Subscribed and sworn to before me this 10th day of April, 1958.

My commission expires Jan. 12, 1960

[Signature]  
(Notary Public)

(SEAL)

**CERTIFICATE OF REGISTRATION**

STATE OF OREGON

County of Marion

} ss.

This is to certify that the foregoing Registration Statement was received in the office of the State Engineer on the 11th day of April, 1958, at 8:00 o'clock A.M. and has been duly recorded in said office in Book No. 7 of Registration Statements on page GR-1253

Witness my hand this 20th day of October, 1958

Lewis A. Stanley  
(State Engineer)

By \_\_\_\_\_  
(Deputy)