

Township 1N Range 3E W.M.
North

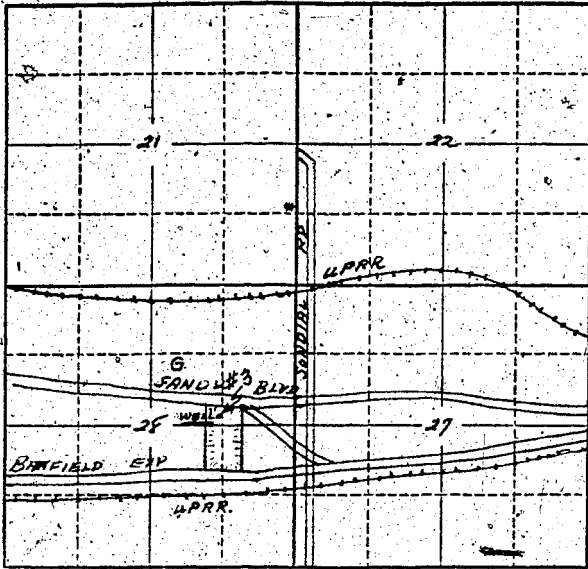

Locate well and acreage of irrigated land on plat.

Scale: 2" = 1 Mile

STATE OF OREGON

County of Multnomah

} ss.

I, Sophie George, being first duly sworn, do hereby certify that I have read the foregoing Registration Statement and that all of the items therein contained are true to the best of my knowledge and belief.

Fairview Farms, Inc.

Secretary

(Signature of Registrant)

Subscribed and sworn to before me this 21st day of March, 1958

My commission expires 3-7-62

B. H. [Signature]

(Notary Public)

(SEAL)

CERTIFICATE OF REGISTRATION

STATE OF OREGON

County of Marion

} ss.

This is to certify that the foregoing Registration Statement was received in the office of the State Engineer on the 18th day of April, 1958, at 4⁰⁰ o'clock P. M. and has been duly recorded in said office in Book No. 7 of Registration Statements on page GR-1586

Witness my hand this 1st day of December, 1958

[Signature]
(State Engineer)

By

(Deputy)

GR-1586

25.00