

North

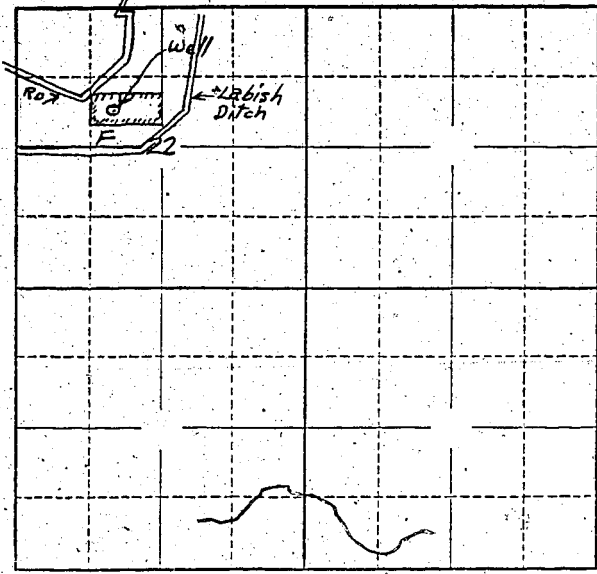

Locate well and acreage of irrigated land on plat.

Scale: 2" = 1 Mile

STATE OF OREGON

County of \_\_\_\_\_ } ss.

I, W.B. Aker - H.B. Aker, being first duly sworn, do hereby certify that I have read the foregoing Registration Statement and that all of the items therein contained are true to the best of my knowledge and belief.

W.B. Aker - H.B. Aker  
(Signature of Registrant)

Subscribed and sworn to before me this 13th day of May, 1958

My commission expires 12th June 1961 Wm. S. Bartholomew  
(Notary Public)

(SEAL)

**CERTIFICATE OF REGISTRATION**

STATE OF OREGON

County of Marion } ss.

This is to certify that the foregoing Registration Statement was received in the office of the State Engineer on the 13th day of May, 1958, at 9:30 o'clock A. M. and has been duly recorded in said office in Book No. 7 of Registration Statements on page GR-1506

Witness my hand this 1st day of December, 1958

[Signature]  
(State Engineer)

By \_\_\_\_\_  
(Deputy)

#1500