

Township T9S Range R1E, W.M.  
North

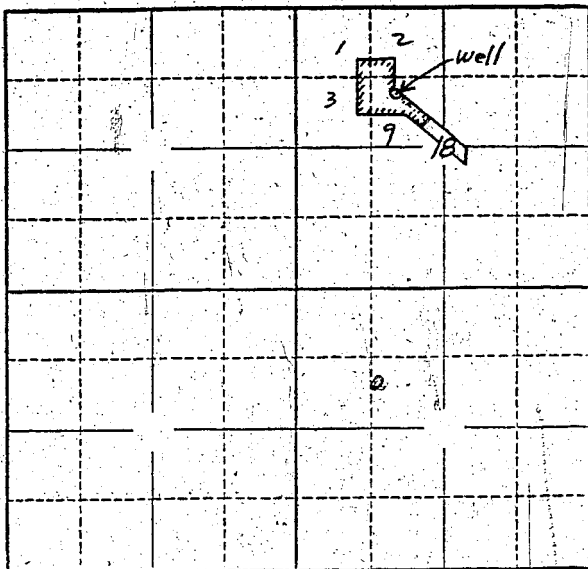

Locate well and acreage of irrigated land on plat.  
Scale: 2" = 1 Mile

STATE OF OREGON

County of Marion

ss.

I, \_\_\_\_\_, being first duly sworn, do hereby certify that I have read the foregoing Registration Statement and that all of the items therein contained are true to the best of my knowledge and belief.

William Geisler  
(Signature of Registrant)

Subscribed and sworn to before me this 15th day of May, 1958

My commission expires 12th June 1961

Wm. S. Bartholomew  
(Notary Public)

(SEAL)

**CERTIFICATE OF REGISTRATION**

STATE OF OREGON

County of Marion

ss.

This is to certify that the foregoing Registration Statement was received in the office of the State Engineer on the 15th day of May, 1958, at 4:00 o'clock P.M. and has been duly recorded in said office in Book No. 7 of Registration Statements on page GR-1512

Witness my hand this 1st day of December, 1958

Henry A. Stanley  
(State Engineer)

By \_\_\_\_\_ (Deputy)

#15.00

GR - 1512