

North

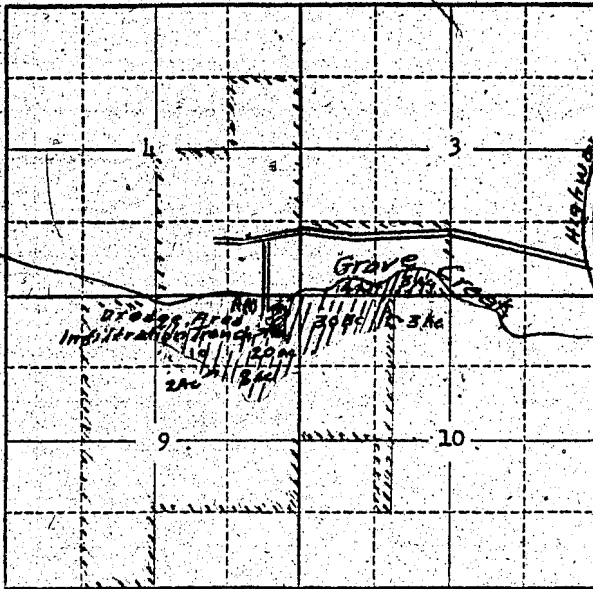

Locate well and acreage of irrigated land on plat.

Scale: 2" = 1 Mile

STATE OF OREGON

County of Josephine

I, John M. Biencourt, being first duly sworn, do hereby certify that I have read the foregoing Registration Statement and that all of the items therein contained are true to the best of my knowledge and belief.

John M. Biencourt (Signature of Registrant)

Subscribed and sworn to before me this 30 day of March, 1956

My commission expires Dec 12-1958

Grace R. Robbins (Notary Public)

(SEAL)

CERTIFICATE OF REGISTRATION

STATE OF OREGON

County of Marion

This is to certify that the foregoing Registration Statement was received in the office of the State Engineer on the 5th day of April, 1956, at 8 o'clock A.M. and has been duly recorded in said office in Book No. J of Registration Statements on page GR-151 C

Construction shall be completed by 1958 and the water completely applied to beneficial use by 1958

Witness my hand this 8th day of October, 1956

Lewis A. Stanley (State Engineer)

By (Deputy)