

North

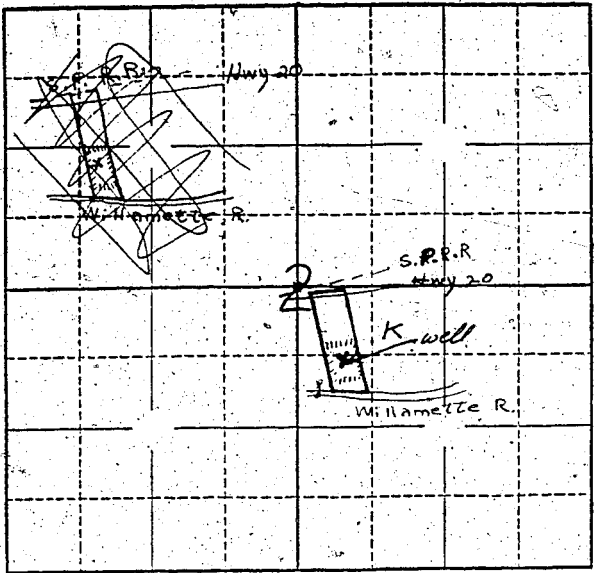

Locate well and acreage of irrigated land on plat.

Scale: 1" = 1 Mile  
4" = 1

STATE OF OREGON

County of Benton } ss.

I, Fielding C. Parker, being first duly sworn, do hereby certify that I have read the foregoing Registration Statement and that all of the items therein contained are true to the best of my knowledge and belief.

Fielding C. Parker  
(Signature of Registrant)

Subscribed and sworn to before me this 20th day of May, 1958

My commission expires 4/16/60

Alphina B. Bingham  
(Notary Public)

(SEAL)

**CERTIFICATE OF REGISTRATION**

STATE OF OREGON } ss.  
County of Marion

This is to certify that the foregoing Registration Statement was received in the office of the State Engineer on the 21st day of May, 1958, at 8:00 o'clock A. M. and has been duly recorded in said office in Book No. 7 of Registration Statements on page GR-1539

Witness my hand this 1st day of December, 1958

Lewis A. Stanley  
(State Engineer)

\$15.00

By \_\_\_\_\_ (Deputy)