

Township 2 N Range 1 E, W.M.
North

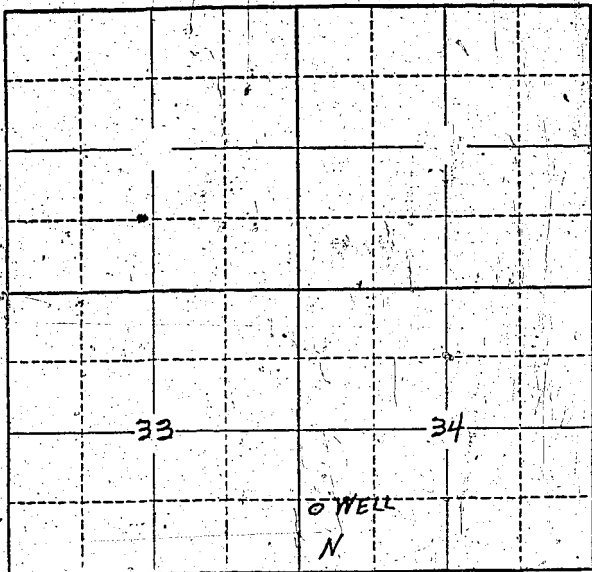

Locate well and acreage of irrigated land on plat.

Scale: 2" = 1 Mile

STATE OF OREGON

County of MULTNOMAH

ss.

I, RUTH TURPIN, SECRETARY OF REGISTRANT being first duly sworn, do hereby certify that I have read the foregoing Registration Statement and that all of the items therein contained are true to the best of my knowledge and belief, and make this verification for and on behalf of said Registrant.

Ruth Turpin
(Signature of Registrant)

Subscribed and sworn to before me this 20th day of May, 1958

My commission expires May 31, 1959

(Notary Public)

(SEAL)

CERTIFICATE OF REGISTRATION

STATE OF OREGON

County of Marion

ss.

This is to certify that the foregoing Registration Statement was received in the office of the State Engineer on the 22nd day of May, 1958, at 6:00 o'clock A.M. and has been duly recorded in said office in Book No. 7 of Registration Statements on page GR-1512

Witness my hand this 1st day of December, 1958

Lewis A. Stebbins
(State Engineer)

By _____ (Deputy)

GR - 1512

\$ 24.00