

Township 6N Range 35E, W.M.

North

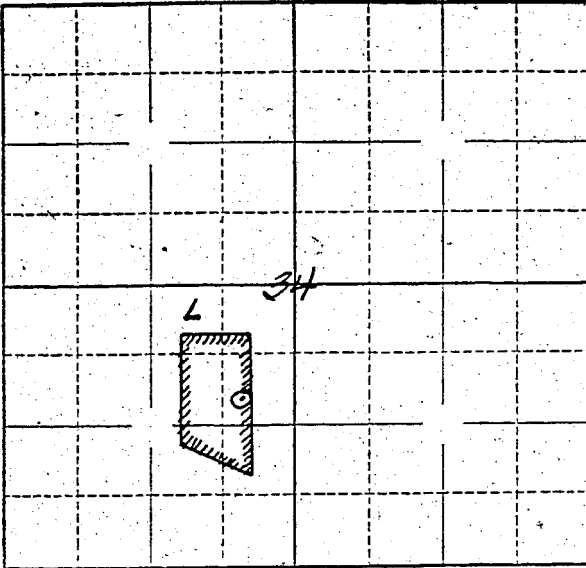

Locate well and acreage of irrigated land on plat.

Scale: $\frac{1}{4}$ - 1 Mile

STATE OF OREGON

County of WATSON } ss.

I, Donald L. White, being first duly sworn, do hereby certify that I have read the foregoing Registration Statement and that all of the items therein contained are true to the best of my knowledge and belief.

Donald L. White
(Signature of Registrant)

Subscribed and sworn to before me this _____ day of _____, 19 _____.

My commission expires _____ (Notary Public)

(SEAL)

CERTIFICATE OF REGISTRATION

STATE OF OREGON }
County of Marion } ss.

This is to certify that the foregoing Registration Statement was received in the office of the State Engineer on the 30th day of May, 1958, at 5:00 o'clock A.M. and has been duly recorded in said office in Book No. 7 of Registration Statements on page GR 1545

Witness my hand this 1st day of December, 1958.

Lewis A. Sloman
(State Engineer)

By _____ (Deputy)

\$15.00