

Section 27

Township 6S Range 35E, W.M.

North

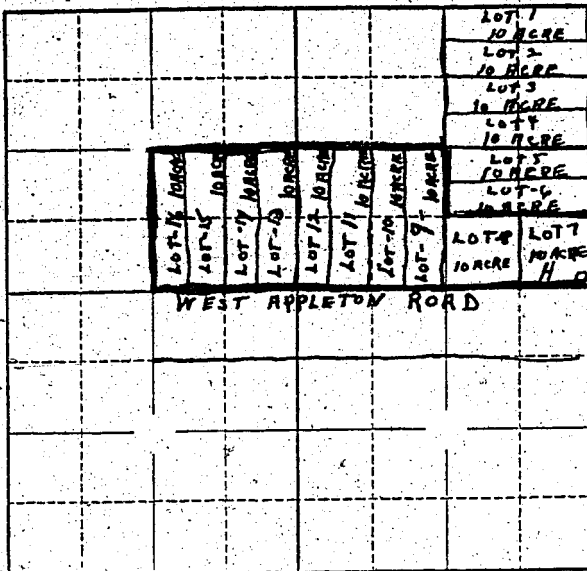

Locate well and acreage of irrigated land on plat.

SCALE = 1-MILE

STATE OF OREGON

County of Wasilla

ss.

I, Nauman Kessler, being first duly sworn, do hereby certify that I have read the foregoing Registration Statement and that all of the items therein contained are true to the best of my knowledge and belief.

[Signature]  
(Signature of Registrant)

Subscribed and sworn to before me this 6<sup>th</sup> day of March, 1958.

My commission expires Sept. 8, 1960

[Signature]  
(Notary Public)

(SEAL)

CERTIFICATE OF REGISTRATION

STATE OF OREGON

County of Marion

ss.

This is to certify that the foregoing Registration Statement was received in the office of the State Engineer on the 29<sup>th</sup> day of May, 1958, at 2:00 o'clock A. M. and has been duly recorded in said office in Book No. 7 of Registration Statements on page GR-1596

Witness my hand this 7<sup>th</sup> day of January, 1959.

# 25.50

[Signature]  
(State Engineer)

By \_\_\_\_\_ (Deputy)