

lot 29s
Bosky Del
see caption

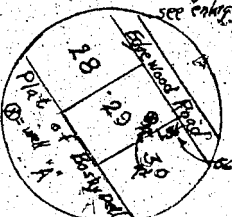

Locate well and acreage of irrigated land on plat.

Scale: 2" = 1 Mile

STATE OF OREGON

County of Clackamas

I, E. P. Pearson, being first duly sworn, do hereby certify that I have read the foregoing Registration Statement and that all of the items therein contained are true to the best of my knowledge and belief.

E. P. Pearson
(Signature of Registrant)

Subscribed and sworn to before me this 4th day of June, 1958

My commission expires Aug 31, 1959

Frank J. Filpp
(Notary Public)

(SEAL)

CERTIFICATE OF REGISTRATION

STATE OF OREGON

County of Marion

This is to certify that the foregoing Registration Statement was received in the office of the State Engineer on the 6th day of June, 1958, at 8.00 o'clock A.M. and has been duly recorded in said office in Book No. 7 of Registration Statements on page GR-1610

Witness my hand this 7th day of January, 1959

Lewis A. Stanley
(State Engineer)

By _____ (Deputy)

\$15.00