

North

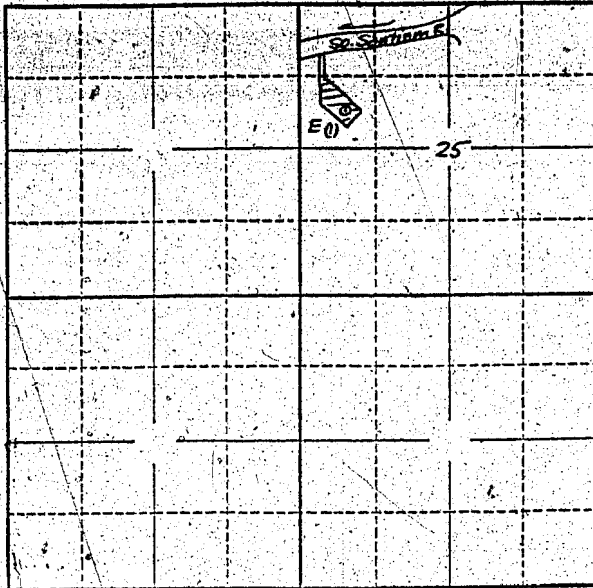

Locate well and acreage of irrigated land on plat.

Scale: 2" = 1 Mile

STATE OF OREGON

County of Linn

ss.

I, Harvey Reeser, being first duly sworn, do hereby certify that I have read the foregoing Registration Statement and that all of the items therein contained are true to the best of my knowledge and belief.

Harvey Reeser (Signature of Registrant)

Subscribed and sworn to before me this 23 day of April, 1956

My commission expires March 13, 1959

Notary Public (Signature)

(SEAL)

CERTIFICATE OF REGISTRATION

STATE OF OREGON

County of Marion

ss.

This is to certify that the foregoing Registration Statement was received in the office of the State Engineer on the 26th day of April, 1956, at 8 o'clock A.M. and has been duly recorded in said office in Book No. 1 of Registration Statements on page GR-158 C.

Construction shall be completed by [redacted] and the water shall be completely applied to beneficial use by October 1, 1958.

Witness my hand this 8th day of October, 1956

Lewis A. Stanley (State Engineer)

By (Deputy)