

North

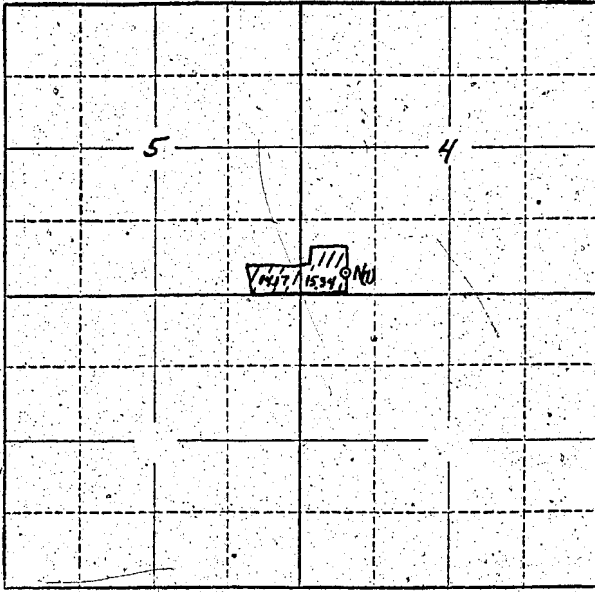

Locate well and acreage of irrigated land on plat.

Scale: 2" = 1 Mile

STATE OF OREGON

County of Marion } ss.

Pletzer L.

xx We Pearl F. and Ernest Pletzer being first duly sworn, do hereby certify that I have read the foregoing Registration Statement and that all of the items therein contained are true to the best of my knowledge and belief.

Pearl F. Pletzer

Ernest B. Pletzer
(Signature of Registrant)

Subscribed and sworn to before me this 3rd day of May, 1955

My commission expires Sept. 25, 1958.

Russell [Signature]
(Notary Public)

(SEAL)

For Certificate See Page GR-161 K
-CERTIFICATE OF REGISTRATION

STATE OF OREGON

County of Marion } ss.

~~This is to certify that the foregoing Registration Statement was recorded in the office of the State Engineer on the _____ day of _____, 19____, and that the same is a true and correct copy of the original as the same appears in the books of the State Engineer. I, _____, State Engineer, do hereby certify that the same is a true and correct copy of the original as the same appears in the books of the State Engineer.~~

Witness my hand this _____ day of _____, 19____

(State Engineer)

By _____ (Deputy)

GR-161 C

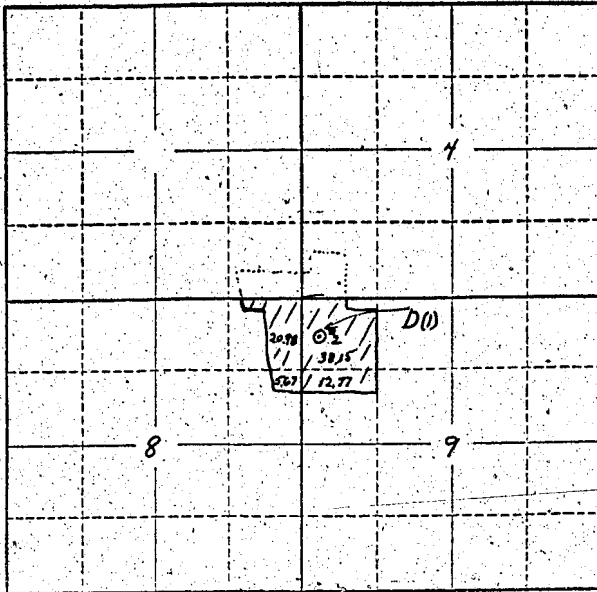

Locate well and acreage of irrigated land on plat.
Scale: 2" = 1 Mile

STATE OF OREGON

County of Marion

ss.

I, Pearl F. Pletzer,

being first duly sworn, do hereby certify that I have read the foregoing Registration Statement and that all of the items therein contained are true to the best of my knowledge and belief.

Pearl F. Pletzer

Ernest F. Pletzer
(Signature of Registrant)

Subscribed and sworn to before me this 3rd day of May, 1956

My commission expires Sept. 25, 1956.

Robert Thomas
(Notary Public)

(SEAL)

For Certificate See Page GR-161 K
CERTIFICATE OF REGISTRATION

STATE OF OREGON

County of Marion

ss.

~~This do hereby certify that the foregoing Registration Statement of _____ is true to the best of my knowledge and belief.~~
~~My commission expires _____~~
~~_____~~
~~_____~~

Witness my hand this _____ day of _____, 19_____

(State Engineer)

By _____

(Deputy)

North

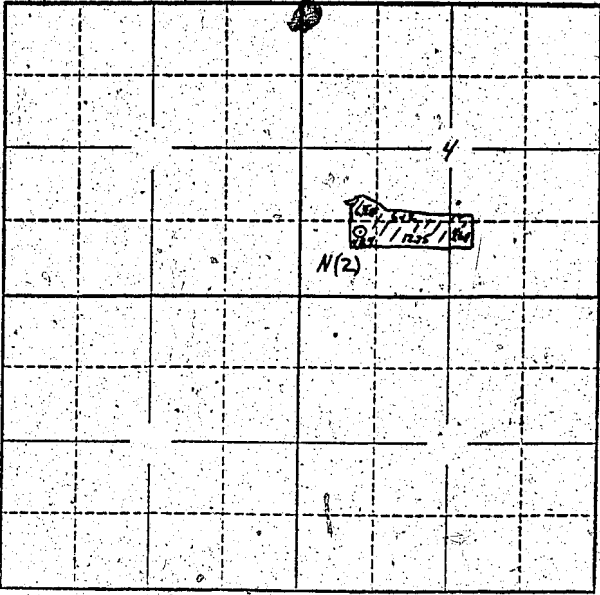

Locate well and acreage of irrigated land on plat.

Scale: 2" = 1 Mile

STATE OF OREGON

County of Marion } ss.

L. Pletzer,
Mr. Pearl F. Pletzer and Ernest, being first duly sworn, do hereby certify that I have read the foregoing Registration Statement and that all of the items therein contained are true to the best of my knowledge and belief.

Pearl F. Pletzer Ernest L. Pletzer
(Signature of Registrant)

Subscribed and sworn to before me this 3rd day of May, 1956.

My commission expires Sept. 25, 1958.
Ronald H. Brown
(Notary Public)

(SEAL)

CERTIFICATE OF REGISTRATION

STATE OF OREGON } ss.
County of Marion

This is to certify that the foregoing Registration Statement was received in the office of the State Engineer on the 5th day of April, 1956, at 12:45 o'clock P.M. and has been duly recorded in said office in Book No. 1 of Registration Statements on page GR-161 K.

~~Construction shall be completed by _____ and the record copy filed in _____~~
~~_____~~

Witness my hand this 8th day of October, 1956.

Lewis A. Stanley
(State Engineer)

By _____
(Deputy)