

North

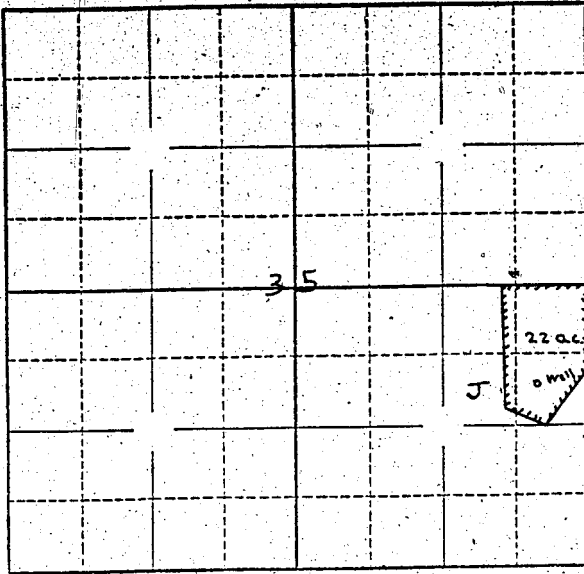

Locate well and acreage of irrigated land on plat.

Scale: $\frac{2\frac{1}{2}}{4}$ = 1 Mile

STATE OF OREGON

County of Marion } ss.

I, Archie Claggett, being first duly sworn, do hereby certify that I have read the foregoing Registration Statement and that all of the items therein contained are true to the best of my knowledge and belief.

Archie Claggett
(Signature of Registrant)

Subscribed and sworn to before me this 11th day of June, 1958

My commission expires September 8, 1960

Harold Rogers
(Notary Public)

(SEAL)

CERTIFICATE OF REGISTRATION

STATE OF OREGON

County of Marion } ss.

This is to certify that the foregoing Registration Statement was received in the office of the State Engineer on the 10th day of June, 1958, at 11:00 o'clock M. and has been duly recorded in said office in Book No. 8 of Registration Statements on page GR-1656

~~Construction shall be completed by~~ and the water completely applied to beneficial use by 19.....

Witness my hand this 7th day of January, 1959

Henry A. Ottum
(State Engineer)

By (Deputy)

\$1500