

North

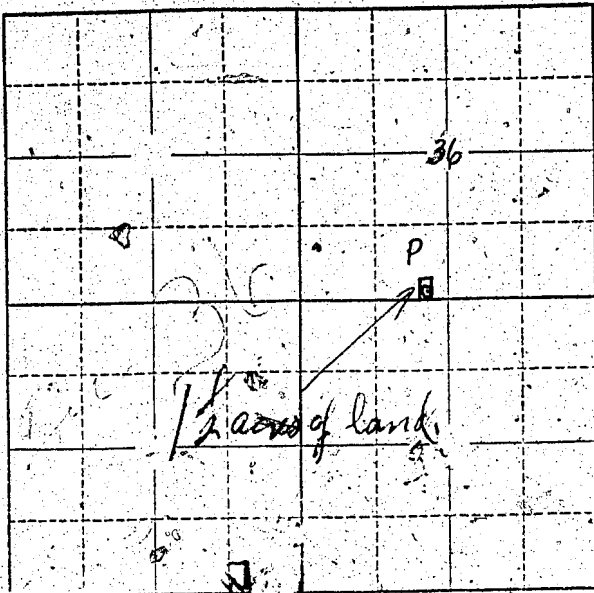

Sec 36

Locate well and acreage of irrigated land on plat.

Scale: 2" = 1 Mile

4" = 1/2 Mile

STATE OF OREGON

County of Jackson } ss.

I, Frank B. Hazelton, being first duly sworn, do hereby certify that I have read the foregoing Registration Statement and that all of the items therein contained are true to the best of my knowledge and belief.

Frank B. Hazelton
(Signature of Registrant)

Subscribed and sworn to before me this 4 day of April, 1960

My commission expires MY COMMISSION EXPIRES JULY 29, 1963

Margaret J. Apple
(Notary Public)

(SEAL)

CERTIFICATE OF REGISTRATION

STATE OF OREGON } ss.
County of Marion

This is to certify that the foregoing Registration Statement was received in the office of the State Engineer on the 15th day of June, 1960, at 2:00 o'clock P.M. and has been duly recorded in said office in Book No. 17 of Registration Statements on page GR 4047

~~Construction shall be completed by _____ and the water promptly applied to _____~~
~~_____~~

Witness my hand this 16th day of May, 1960
Lewis A. Stanley
(State Engineer)

By _____
(Deputy)

#1500