

Township 18 Range 3E W.M.

North STARK ST. IN 3E

TOWNSHIP CORNER

IN 4E

15 4E

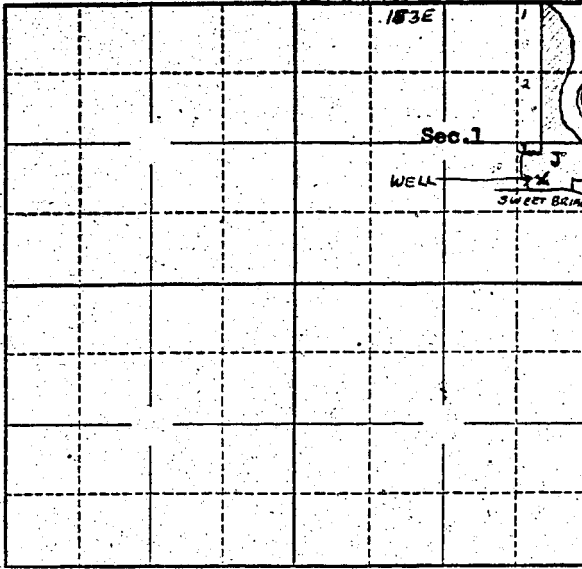

AREA IRRIGATED FROM WELL

Locate well and acreage of irrigated land on plat.

Scale: 2" = 1 Mile

STATE OF OREGON

County of _____ } ss.

I, W. P. Nuffer, being first duly sworn, do hereby certify that I have read the foregoing Registration Statement and that all of the items therein contained are true to the best of my knowledge and belief.

Mountain View Farms, Inc
W. P. Nuffer (in time)
(Signature of Registrant)

Subscribed and sworn to before me this 19th day of June, 1958

My commission expires 10-10-59
Mildred Belt
(Notary Public)

(SEAL)

CERTIFICATE OF REGISTRATION

STATE OF OREGON } ss.
County of Marion

This is to certify that the foregoing Registration Statement was received in the office of the State Engineer on the 23rd day of June, 1958, at 8⁰⁰ o'clock A. M. and has been duly recorded in said office in Book No. 8 of Registration Statements on page GR-1713

Witness my hand this 7th day of January, 1959
Lewis A. Stanley
(State Engineer)

.By _____
(Deputy)

GR-1713

\$16.50