

Township 4 N Range 2 W, W.M.

North

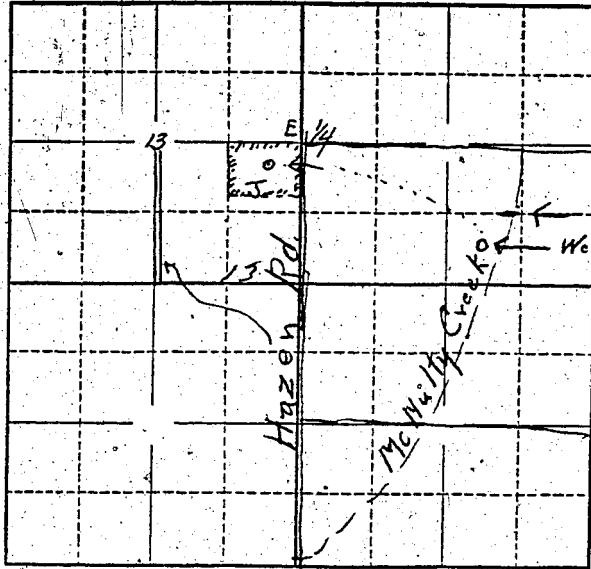

Have water rights to
Mc Nulty Creek
For 150 gal Per Min.

200
Dam 275' From Well
Well 205' Deep at 150 gal
Per Min.

Locate well and acreage of irrigated land on plat.

Scale: 2" = 1 Mile

STATE OF OREGON

County of COLUMBIA } ss.

I, JOHN G. JOHNSON, being first duly sworn, do hereby certify that I have read the foregoing Registration Statement and that all of the items therein contained are true to the best of my knowledge and belief.

Johnson Bros John G Johnson
(Signature of Registrant)

Subscribed and sworn to before me this 14th day of JUNE, 1958.

My commission expires 10/28th/1960

Herbert L. Selig
(Notary Public)

(SEAL)

CERTIFICATE OF REGISTRATION

STATE OF OREGON } ss.
County of Marion

This is to certify that the foregoing Registration Statement was received in the office of the State Engineer on the 26th day of June, 1958, at 10:00 o'clock A. M. and has been duly recorded in said office in Book No. 8 of Registration Statements on page GR-1752

Witness my hand this 7th day of January, 1959

Lewis G. Stanley
(State Engineer)

By _____ (Deputy)

GR-1752

150